

# LOUISIANA HOUSE OF REPRESENTATIVES

## SUBCOMMITTEE ON REAPPORTIONMENT OF THE COMMITTEE ON HOUSE AND GOVERNMENTAL AFFAIRS

### Congressional Consensus Plan B

#### **Contact Us:**

Louisiana House of Representatives  
Committee on House and Governmental Affairs  
Subcommittee on Reapportionment  
P.O. Box 44486  
Baton Rouge, LA 70804-4486  
Telephone: (225) 342-2403  
Fax: (225) 342-0768  
<http://house.legis.state.la.us>

Congressional Consensus Plan B

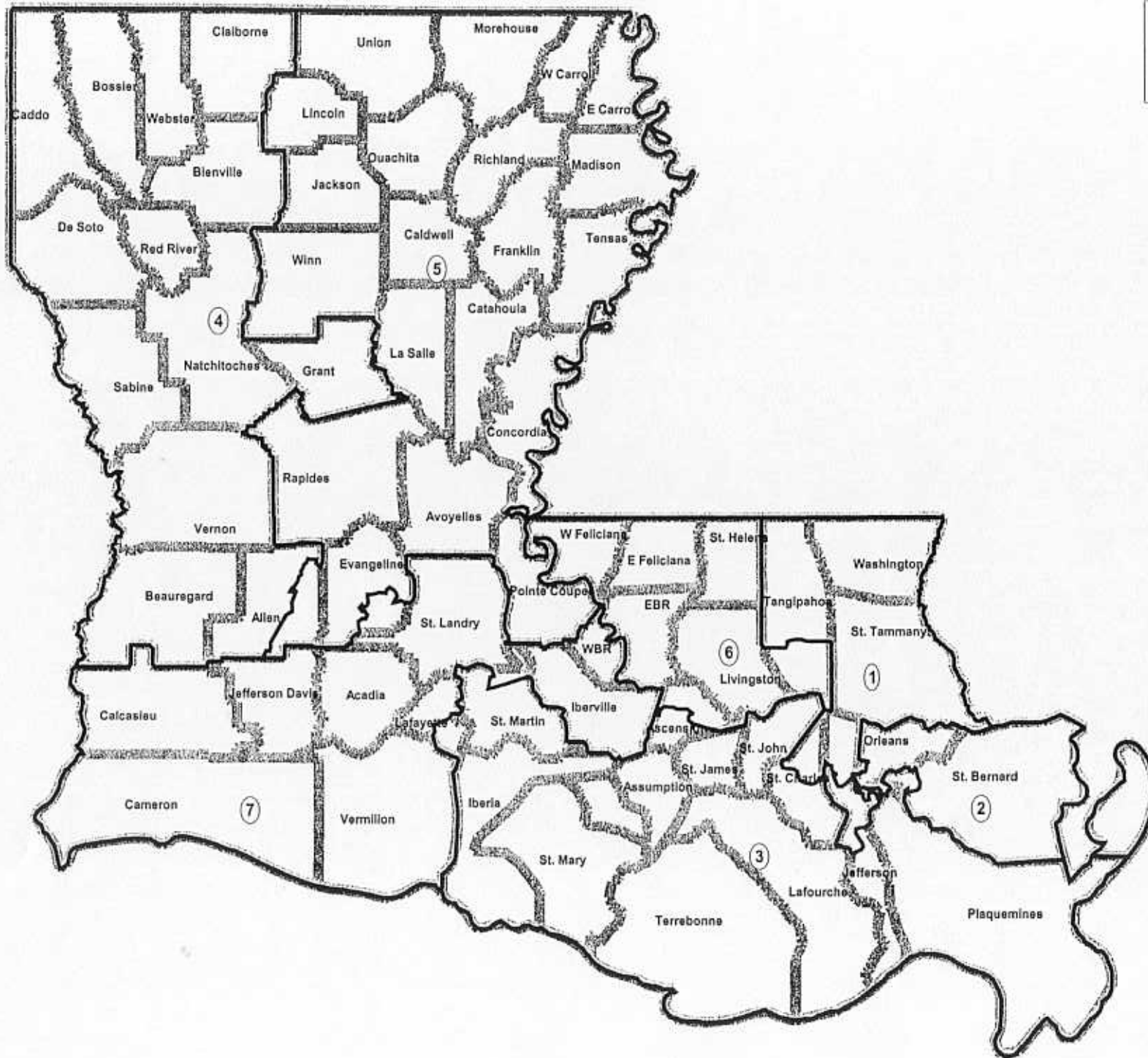

**Legend**  
Map Layers  
Parish  
Districts

**Assigned Districts - Splits****Total Population Ethnic Breakout  
Plan: Congressional Consensus Plan B**

	Tot Pop	Tot White	Tot Black	Tot Asian	Tot Other	Tot Hispanic	Reg Total
Precinct 35	2,413	1,819	513	23	58	88	1,213
Precinct 36	2,696	2,121	529	9	37	34	1,495
Precinct 37	1,857	1,631	192	5	29	42	1,032
Precinct 38	1,720	1,513	142	31	34	34	1,063
Precinct 39	2,687	2,278	304	43	62	57	1,166
Precinct 40	1,210	827	364	12	7	19	726
Precinct 41	1,848	1,405	283	114	46	84	963
Precinct 42	1,837	1,534	205	68	30	34	860
Precinct 43	1,571	1,300	207	33	31	41	979
Precinct 44	1,710	1,382	222	48	58	80	857
Precinct 45	1,881	1,595	196	52	38	53	981
Precinct 46	807	755	40	4	8	10	593
Precinct 47	1,343	1,227	59	25	32	25	815
Precinct 48	860	827	9	10	14	16	675
Precinct 49	1,343	1,302	25	6	10	21	1,058
Precinct 50	539	89	436	3	11	7	325
Precinct 51	1,415	97	1,306	1	11	7	869
Precinct 52	1,332	480	835	7	10	14	667
Precinct 53	1,024	405	613	2	4	4	624
Precinct 54	1,568	75	1,484	2	7	14	959
Precinct 55	1,701	889	785	11	16	22	1,069
Precinct 56	1,600	187	1,393	2	18	14	1,159
Precinct 57	1,769	529	1,207	16	17	19	949
Precinct 58	770	12	753	2	3	10	588
Precinct 59	624	377	241	0	6	2	427
Precinct 60	1,258	809	435	9	5	11	757
Precinct 61	597	79	516	1	1	4	427
Precinct 62	602	46	549	4	3	6	390
Precinct 63	630	229	380	14	7	7	400
Precinct 64	1,974	1,135	803	17	19	22	1,007
Precinct 65	1,022	760	211	21	30	21	511
Precinct 66	967	709	225	15	18	17	539
Precinct 67	1,766	1,554	109	66	37	44	980
Precinct 68	2,294	1,004	1,212	10	68	84	929
Precinct 69	867	846	10	5	6	8	550
Precinct 70	1,110	1,068	16	11	15	20	764
Precinct 71	1,284	1,005	259	4	16	17	698
Precinct 72	2,237	1,304	778	121	34	57	401
Precinct 73	695	683	10	1	1	13	562
Precinct 74	1,683	1,398	95	164	26	78	882
Precinct 75	1,192	1,029	99	39	25	55	612
Precinct 76	1,501	1,455	25	10	11	9	991
Precinct 77	1,378	1,319	32	15	12	13	873

## Assigned Districts - Splits

Total Population Ethnic Breakout  
Plan: Congressional Consensus Plan B

DB: GEO\_LA\_HSE

Plan Type: Congress7

	Tot Pop	Tot White	Tot Black	Tot Asian	Tot Other	Tot Hispanic	Reg Total
Precinct 2-4	397	373	21	0	3	3	215
Precinct 3-2	892	506	379	3	4	3	576
Precinct 3-3	1,651	1,161	471	3	16	25	1,033
Precinct 3-5	846	773	62	2	9	16	509
Precinct 3-6	668	311	355	0	2	1	423
<b>Evangeline</b>	<b>17,058</b>	<b>9,498</b>	<b>7,458</b>	<b>23</b>	<b>79</b>	<b>191</b>	<b>11,015</b>
Iberville	33,320	16,412	16,631	97	180	343	19,697
Jefferson Davis	31,435	25,337	5,718	84	296	312	19,029
* Lafayette							
Precinct 1	2,299	1,827	410	24	38	47	1,267
Precinct 2	3,149	2,522	583	10	34	38	1,843
Precinct 3	1,651	1,494	140	7	10	17	871
Precinct 4	3,259	2,116	1,109	6	28	30	1,774
Precinct 5	1,445	570	859	12	4	11	859
Precinct 6	2,433	1,947	461	8	17	38	1,450
Precinct 7	1,870	1,044	813	0	13	7	1,123
Precinct 8	2,918	1,921	961	13	23	49	1,581
Precinct 9	2,740	1,995	683	21	41	36	1,573
Precinct 10	1,872	1,385	435	25	27	28	769
Precinct 11	3,029	2,175	742	47	65	65	1,574
Precinct 12	2,003	1,618	353	7	25	29	1,299
Precinct 13	1,615	1,231	360	15	9	20	1,161
Precinct 14	2,010	724	1,265	7	14	32	934
Precinct 15	729	131	593	3	2	9	498
Precinct 16	1,242	590	638	1	13	19	618
Precinct 17	1,714	431	1,273	1	9	18	859
Precinct 18	1,384	101	1,280	1	2	4	1,005
Precinct 19	1,950	29	1,910	2	9	10	1,388
Precinct 20	1,407	580	808	10	9	11	900
Precinct 21	1,387	419	946	5	17	20	705
Precinct 22	708	61	639	2	6	6	479
Precinct 23	1,223	77	1,122	0	24	22	816
Precinct 24	2,299	269	2,018	0	12	11	1,109
Precinct 25	1,143	1,062	57	0	24	11	570
Precinct 26	1,488	1,110	358	10	10	14	935
Precinct 27	1,396	1,087	304	3	2	5	933
Precinct 28	2,528	2,340	151	8	29	13	1,384
Precinct 29	3,151	2,903	172	42	34	73	1,970
Precinct 30	1,816	1,574	163	50	29	58	1,069
Precinct 31	2,047	1,285	702	28	32	39	992
Precinct 32	2,832	2,319	412	70	31	63	1,413
Precinct 33	1,763	1,646	52	37	28	28	1,185
Precinct 34	1,986	1,721	189	61	15	44	1,108

## Assigned Districts - Splits

Total Population Ethnic Breakout  
Plan: Congressional Consensus Plan B

	Tot Pop	Tot White	Tot Black	Tot Asian	Tot Other	Tot Hispanic	Reg Total
Precinct 122	1,928	1,856	39	3	30	18	1,014
Precinct 122A	702	684	2	1	15	9	328
Precinct 124	863	838	13	1	11	7	442
Precinct 137	4,190	4,119	40	7	24	37	2,360
Precinct 137A	2,482	2,060	363	23	36	40	1,309
Precinct 139	1,026	873	143	0	10	17	404
Precinct 141	1,342	785	531	10	16	15	571
Precinct 141A	823	759	60	0	4	10	531
Precinct 143	2,059	1,346	691	8	14	29	1,146
Precinct 145	2,252	2,147	46	17	42	36	1,157
Precinct 147	390	380	3	3	4	4	265
Precinct 149	2,260	2,211	15	23	11	30	1,458
Precinct 151	1,892	1,865	13	11	3	27	1,079
<b>Tangipahoa</b>	<b>30,867</b>	<b>25,900</b>	<b>4,556</b>	<b>140</b>	<b>271</b>	<b>362</b>	<b>16,923</b>
West Feliciana	15,111	7,348	7,647	39	77	157	6,146
<b>District 6</b>	<b>637,655</b>	<b>417,418</b>	<b>203,001</b>	<b>10,091</b>	<b>7,145</b>	<b>10,587</b>	<b>355,714</b>
<b>District 7</b>							
Acadia	58,861	47,521	10,833	123	384	538	35,070
Calcasieu	183,577	135,107	44,782	1,411	2,277	2,463	112,065
Cameron	9,991	9,357	407	49	178	215	6,872
* Evangeline							
Precinct 1-1-0	772	297	470	0	5	1	408
Precinct 1-1-1	552	255	295	1	1	7	370
Precinct 1-4C	383	195	187	0	1	2	284
Precinct 1-4R	634	466	162	5	1	11	402
Precinct 1-5	928	849	77	0	2	11	583
Precinct 1-6	438	424	11	2	1	3	360
Precinct 1-7	612	23	586	2	1	2	322
Precinct 1-8-0	349	183	166	0	0	11	202
Precinct 1-8-1	162	108	54	0	0	2	105
Precinct 1-8-2	627	106	512	0	9	14	297
Precinct 1-9-0C	306	198	105	1	2	3	198
Precinct 1-9R	503	418	84	1	0	5	346
Precinct 1-10-0	505	430	74	0	1	0	399
Precinct 1-10-1	1,009	748	259	0	2	5	650
Precinct 1-11	1,210	47	1,157	1	5	18	847
Precinct 1-12	1,054	159	889	0	6	18	710
Precinct 1-15	685	525	154	2	4	6	458
Precinct 1-16-1R	225	205	20	0	0	0	123
Precinct 1-16-OR	678	25	653	0	0	6	541
Precinct 1-17-C	569	339	227	0	3	12	381
Precinct 1-17-R	403	374	28	0	1	6	273

Date: Sep 12, 2001

Time: 2:01 PM

**Assigned Districts - Splits**
**Total Population Ethnic Breakout  
Plan: Congressional Consensus Plan B**

DB: GEO\_LA\_HSE

Plan Type: Congress7

Page: 26 of 30

	Tot Pop	Tot White	Tot Black	Tot Asian	Tot Other	Tot Hispanic	Reg Total
Precinct 3	1,580	1,534	29	3	14	13	778
Precinct 4	1,620	1,461	144	4	11	17	925
Precinct 5	2,510	2,356	83	13	58	36	1,294
Precinct 6	1,874	1,558	302	1	13	29	849
Precinct 7	1,069	1,022	36	4	7	6	567
Precinct 8	1,991	1,660	256	5	70	78	918
Precinct 9	2,084	1,311	703	16	54	109	1,030
Precinct 10	1,653	1,565	69	1	18	11	919
Precinct 11	1,514	1,330	165	4	15	18	833
Precinct 12	1,930	1,852	44	5	29	43	1,096
Precinct 13	1,242	1,203	23	2	14	25	643
Precinct 14	1,277	1,256	7	0	14	16	697
Precinct 15	1,469	1,430	4	19	16	15	879
Precinct 16	2,506	2,213	211	31	51	51	1,490
Precinct 17	1,570	1,200	320	13	37	58	823
Precinct 18	1,872	1,759	26	3	84	134	951
Precinct 19	2,975	2,614	278	10	73	113	1,670
Precinct 20	974	939	14	13	8	3	636
Precinct 21	1,241	1,211	25	1	4	20	625
Precinct 22	806	798	0	6	2	10	495
Precinct 23	986	856	99	2	29	44	470
Precinct 24	1,125	975	112	14	24	75	638
Precinct 25	1,716	1,576	54	3	83	93	1,026
Precinct 26	2,645	2,597	14	12	22	19	1,482
Precinct 27	2,226	2,196	8	10	12	20	1,252
Precinct 28	1,244	733	417	4	90	136	592
Precinct 29	1,263	966	266	9	22	50	756
Precinct 33	2,253	2,106	113	8	26	61	1,249
Precinct 34	1,227	1,027	183	2	15	17	834
Precinct 35	1,457	1,394	52	1	10	22	760
Precinct 41	1,336	1,312	9	1	14	18	732
<b>Ascension</b>	<b>55,126</b>	<b>49,899</b>	<b>4,187</b>	<b>256</b>	<b>984</b>	<b>1,427</b>	<b>30,293</b>
East Baton Rouge	412,852	231,886	167,002	9,351	4,613	7,363	227,264
East Feliciana	21,360	11,063	10,107	69	121	157	11,840
Livingston	91,814	86,625	3,952	226	1,011	1,017	55,062
St. Helena	10,525	4,897	5,550	10	68	104	8,186
* Tangipahoa							
Precinct 70	1,857	1,417	419	15	6	15	1,088
Precinct 71	1,434	1,066	361	2	5	16	945
Precinct 72	2,902	1,922	947	9	24	41	1,439
Precinct 73	1,153	929	212	6	6	6	660
Precinct 74	1,312	643	658	1	10	5	727

Date: Sep 12, 2001

Time: 2:01 PM

# Assigned Districts - Splits



## Total Population Ethnic Breakout Plan: Congressional Consensus Plan B

DB: GEO\_LA\_HSE

Plan Type: Congress7

	Tot Pop	Tot White	Tot Black	Tot Asian	Tot Other	Tot Hispanic	Reg Total
Precinct 1-14	879	831	35	7	6	3	582
Precinct 2-1	879	837	38	2	2	7	366
Precinct 2-2	1,584	905	670	6	3	16	464
Precinct 2-3	640	544	90	0	6	2	331
Precinct 2-5	1,092	802	283	5	2	11	674
Precinct 3-1	810	685	120	3	2	5	467
Precinct 3-4	1,456	1,146	292	3	15	28	857
Precinct 3-7	996	829	149	0	18	4	582
Precinct 4-1-0R	445	444	0	1	0	1	244
Precinct 4-1-1R	213	212	0	0	1	0	140
Precinct 4-1-2R	315	127	186	2	0	14	26
Precinct 4-1C	1,087	990	82	4	11	20	568
Precinct 4-2-0	388	359	19	1	9	3	213
Precinct 4-2-1	39	39	0	0	0	0	26
Precinct 4-3	828	777	46	0	5	2	518
Precinct 4-4	254	243	6	0	5	3	148
Precinct 5-1	991	872	97	1	21	14	570
Precinct 5-2	663	584	75	2	2	5	486
Precinct 5-3	354	343	11	0	0	6	243
Precinct 5-4C	356	340	5	1	10	1	229
Precinct 5-4-R	1,002	922	77	1	2	8	547
Precinct 5-5	183	183	0	0	0	3	107
<b>Evangeline</b>	<b>18,376</b>	<b>15,453</b>	<b>2,741</b>	<b>48</b>	<b>134</b>	<b>177</b>	<b>10,272</b>
Franklin	21,263	14,281	6,762	53	167	160	13,072
Jackson	15,397	10,934	4,312	43	108	94	9,804
La Salle	14,282	12,301	1,754	35	192	117	8,895
Lincoln	42,509	24,409	17,079	581	440	492	21,940
Madison	13,728	5,197	8,313	24	194	288	7,700
Morehouse	31,021	17,297	13,521	70	133	230	18,881
Ouachita	147,250	94,947	49,842	1,105	1,356	1,747	84,241
Pointe Coupee	22,763	13,865	8,670	68	160	245	15,606
Rapides	126,337	84,024	38,904	1,237	2,172	1,739	71,096
Richland	20,981	12,791	8,010	60	120	227	12,822
Tensas	6,618	2,874	3,699	13	32	83	4,563
Union	22,803	15,914	6,414	69	406	461	14,601
West Carroll	12,314	9,838	2,327	22	127	166	7,387
Winn	16,894	11,195	5,477	37	185	147	9,153
<b>District 5</b>	<b>638,870</b>	<b>412,965</b>	<b>214,635</b>	<b>3,803</b>	<b>7,447</b>	<b>8,486</b>	<b>370,421</b>
<b>District 6</b>							
* Ascension							
Precinct 1	1,883	1,767	67	16	33	39	1,100
Precinct 2	2,008	1,922	54	20	12	28	1,284

**Assigned Districts - Splits**

DB: GEO\_LA\_HSE

**Total Population Ethnic Breakout  
Plan: Congressional Consensus Plan B**

Plan Type: Congress7

	Tot Pop	Tot White	Tot Black	Tot Asian	Tot Other	Tot Hispanic	Reg Total
Beauregard	32,986	27,790	4,375	256	565	468	17,979
Bienville	15,752	8,651	6,937	31	133	149	9,369
Bossier	98,310	73,403	20,947	1,602	2,358	3,063	51,136
Caddo	252,161	133,424	113,456	2,030	3,251	3,750	135,819
Claiborne	16,851	8,728	8,018	36	69	128	8,631
De Soto	25,494	14,269	10,814	37	374	396	15,120
Grant	18,698	15,973	2,264	54	407	213	11,251
Natchitoches	39,080	22,608	15,205	198	1,069	566	22,128
Red River	9,622	5,568	3,963	21	70	97	6,209
Sabine	23,459	17,048	4,020	66	2,325	642	13,641
Vernon	52,531	38,717	9,518	1,187	3,109	3,111	21,060
Webster	41,831	27,405	13,841	122	463	378	24,104
<b>District 4</b>	<b>638,510</b>	<b>404,220</b>	<b>214,179</b>	<b>5,897</b>	<b>14,414</b>	<b>13,868</b>	<b>342,968</b>
<b>District 5</b>							
* Allen							
Precinct 1-2	354	283	71	0	0	3	205
Precinct 1-4	533	67	462	2	2	1	335
Precinct 1-5	347	237	101	0	9	10	169
Precinct 2-1	742	369	135	0	238	9	404
Precinct 2-4-O	2,390	836	1,495	4	55	21	529
Precinct 2-5	296	12	283	0	1	0	188
Precinct 5-1	631	535	79	3	14	25	303
Precinct 5-3	1,134	1,088	32	2	12	9	629
Precinct 5-4-C	840	758	72	1	9	3	458
Precinct 5-4-O	829	785	34	0	10	4	486
Precinct 5-7	722	14	699	0	9	2	419
Precinct 5-8	822	338	461	5	18	20	368
Precinct 5-9	1,001	600	371	7	23	12	546
Precinct 5-11	557	429	112	0	16	15	245
Precinct 5-12	161	57	103	0	1	3	93
Precinct 5-13	2,346	1,247	1,000	88	11	902	0
<b>Allen</b>	<b>13,705</b>	<b>7,655</b>	<b>5,510</b>	<b>112</b>	<b>428</b>	<b>1,039</b>	<b>5,377</b>
Avoyelles	41,481	28,402	12,362	93	624	404	23,201
Caldwell	10,560	8,493	1,901	21	145	157	6,513
Catahoula	10,920	7,838	2,982	16	84	101	7,633
Concordia	20,247	12,300	7,702	56	189	300	11,970
East Carroll	9,421	2,977	6,353	40	51	112	5,694
* Evangeline							
Precinct 1-2	305	232	71	0	2	1	183
Precinct 1-3	1,741	1,440	292	1	8	11	1,128
Precinct 1-13-0	639	541	97	0	1	8	455
Precinct 1-13-1	237	226	0	8	3	1	118



# Assigned Districts - Splits

## Total Population Ethnic Breakout

### Plan: Congressional Consensus Plan B



	Tot Pop	Tot White	Tot Black	Tot Asian	Tot Other	Tot Hispanic	Reg Total
Precinct 5-1	647	637	3	1	6	9	333
Precinct 5-2	1,591	1,567	15	1	8	6	1,081
Precinct 5-3 & 5-4	3,753	2,968	751	1	33	23	2,405
Precinct 6-1	1,183	834	341	0	8	4	804
Precinct 6-2	740	532	194	4	10	12	523
Precinct 6-3	1,013	856	150	1	6	6	558
Precinct 6-4	2,471	1,742	703	19	7	26	1,437
Precinct 7-1	1,636	1,043	563	13	17	18	892
Precinct 7-2	807	427	373	1	6	6	288
Precinct 7-3	2,339	273	2,056	4	6	4	1,457
Precinct 7-4	1,341	468	864	0	9	16	768
Precinct 8-1	1,531	1,108	152	261	10	6	967
Precinct 8-2	208	185	22	0	1	4	135
Precinct 8-4	2,153	1,872	266	1	14	16	1,274
Precinct 9-1	1,036	856	171	1	8	5	641
Precinct 9-2	1,147	693	438	7	9	10	721
Precinct 9-3	1,816	1,363	432	9	12	3	1,169
Precinct 9-4	793	687	103	0	3	8	520
Precinct 9-5	931	747	175	0	9	2	562
<b>St. Martin</b>	<b>46,840</b>	<b>30,461</b>	<b>15,546</b>	<b>478</b>	<b>355</b>	<b>389</b>	<b>28,899</b>
St. Mary	53,500	33,591	17,197	931	1,781	1,152	31,475
Terrebonne	104,503	77,401	18,967	1,020	7,115	1,631	53,917
<b>District 3</b>	<b>638,815</b>	<b>458,213</b>	<b>154,587</b>	<b>7,958</b>	<b>18,057</b>	<b>12,173</b>	<b>370,230</b>
<b>District 4</b>							
* Allen							
Precinct 1-1	788	593	177	1	17	8	506
Precinct 1-3	486	342	139	1	4	6	240
Precinct 1-6	640	512	114	3	11	3	328
Precinct 1-7	381	374	6	0	1	2	208
Precinct 2-2	1,151	1,071	26	11	43	19	639
Precinct 2-3	498	493	0	0	5	0	309
Precinct 2-4-C	1,067	964	77	1	25	16	615
Precinct 2-6	1,102	864	187	23	28	1	475
Precinct 3-1	505	474	22	2	7	0	301
Precinct 3-2	1,167	1,128	21	5	13	5	642
Precinct 4-1	424	416	2	0	6	1	207
Precinct 4-2	575	567	3	0	5	6	345
Precinct 4-3	687	669	4	0	14	10	441
Precinct 5-2	799	729	41	8	21	16	437
Precinct 5-5	403	399	0	0	4	2	240
Precinct 5-10	1,062	1,041	2	2	17	12	588
<b>Allen</b>	<b>11,735</b>	<b>10,636</b>	<b>821</b>	<b>57</b>	<b>221</b>	<b>187</b>	<b>6,521</b>

Date: Sep 12, 2001

Time: 2:01 PM

DB: GEO\_LA\_HSE

Plan Type: Congress7

# Assigned Districts - Splits

## Total Population Ethnic Breakout Plan: Congressional Consensus Plan B



	Tot Pop	Tot White	Tot Black	Tot Asian	Tot Other	Tot Hispanic	Reg Total
Precinct 2-1	683	610	53	2	18	16	408
Precinct 2-2	917	677	221	4	15	34	423
Precinct 2-3	1,455	1,351	70	3	31	35	883
Precinct 2-4	1,285	834	443	2	6	13	796
Precinct 2-5	2,379	2,227	101	35	16	45	1,576
Precinct 4-1	2,143	1,806	283	8	46	53	1,263
Precinct 4-2	1,750	1,694	30	4	22	26	1,032
Precinct 4-3	1,173	1,090	51	4	28	27	610
Precinct 4-4	1,226	559	646	2	19	24	622
Precinct 7-1	801	643	140	5	13	22	526
Precinct 7-2	1,828	1,737	61	9	21	40	1,165
Precinct 7-3	2,392	2,066	253	36	37	83	1,425
Precinct 7-4	1,516	492	997	9	18	49	764
<b>St. Charles</b>	<b>23,991</b>	<b>17,197</b>	<b>6,349</b>	<b>129</b>	<b>316</b>	<b>511</b>	<b>14,030</b>
St. James	21,216	10,606	10,512	15	83	130	13,819
St. John the Baptist	43,044	22,633	19,416	295	700	1,230	25,188
* St. Martin							
Precinct 1-1	804	654	135	8	7	3	528
Precinct 1-2	306	302	0	1	3	1	181
Precinct 1-3	717	451	258	3	5	2	495
Precinct 1-4	785	577	202	1	5	5	463
Precinct 1-5	1,266	1,230	0	1	35	20	666
Precinct 1-6	300	163	121	2	14	34	124
Precinct 1-7	607	478	123	1	5	7	460
Precinct 2-1 & 2-3	2,351	77	2,266	3	5	10	1,683
Precinct 2-2	2,707	1,754	851	80	22	30	1,454
Precinct 2-4	61	29	29	3	0	0	59
Precinct 3-1	922	153	758	2	9	3	587
Precinct 3-2	681	188	490	1	2	3	364
Precinct 3-3	950	272	669	0	9	11	637
Precinct 3-4	1,294	883	403	1	7	14	753
Precinct 3-5	150	89	60	0	1	0	79
Precinct 3-6	449	176	272	0	1	7	268
Precinct 3-7	119	28	90	1	0	0	64
Precinct 3-8	181	5	175	0	1	5	153
Precinct 3-9	71	2	67	0	2	3	63
Precinct 4-1	586	441	144	0	1	5	429
Precinct 4-2	467	363	99	2	3	6	328
Precinct 4-3	1,509	1,184	263	43	19	8	904
Precinct 4-4	1,274	993	268	1	12	19	885
Precinct 4-5	985	973	7	0	5	9	583
Precinct 4-6	162	138	24	0	0	0	154

## Assigned Districts - Splits

Total Population Ethnic Breakout  
Plan: Congressional Consensus Plan B

	Tot Pop	Tot White	Tot Black	Tot Asian	Tot Other	Tot Hispanic	Reg Total
<b>Lafayette</b>	<b>51,098</b>	<b>45,346</b>	<b>4,499</b>	<b>624</b>	<b>629</b>	<b>972</b>	<b>30,075</b>
Lafourche	89,974	74,544	11,548	684	3,198	1,284	49,342
* Orleans							
Precinct 15-19A	1,147	896	131	89	31	30	693
<b>Orleans</b>	<b>1,147</b>	<b>896</b>	<b>131</b>	<b>89</b>	<b>31</b>	<b>30</b>	<b>693</b>
Plaquemines	26,757	18,668	6,328	788	973	433	15,839
* St. Bernard							
Precinct 10	1,431	1,294	63	19	55	95	900
Precinct 11	1,277	1,221	2	19	35	79	803
Precinct 12	1,177	1,146	10	9	12	45	840
Precinct 13	845	831	0	9	5	23	640
Precinct 14	1,519	1,489	1	10	19	103	1,098
Precinct 15	894	876	0	9	9	33	671
Precinct 16	2,060	1,954	6	75	25	75	1,507
Precinct 17	2,102	1,934	38	45	85	123	1,230
Precinct 18	1,011	970	1	34	6	23	803
Precinct 20	615	607	0	4	4	21	474
Precinct 21	863	833	1	19	10	28	601
Precinct 22	467	465	0	2	0	14	346
Precinct 23	2,922	1,781	601	283	257	396	797
Precinct 24	2,182	2,056	26	59	41	124	1,101
Precinct 25	687	659	0	8	20	26	467
Precinct 26	1,592	1,536	5	11	40	84	1,002
Precinct 27	1,904	1,826	15	22	41	93	1,059
Precinct 28	1,958	1,890	2	31	35	72	1,265
Precinct 30	430	402	16	6	6	10	268
Precinct 31	2,294	2,130	106	27	31	96	1,340
Precinct 32 & 33	3,643	3,526	1	55	61	144	2,694
Precinct 34	2,399	2,307	14	15	63	88	1,594
Precinct 35	2,014	1,971	1	19	23	50	1,421
Precinct 36	1,485	1,446	4	25	10	41	1,021
Precinct 40	625	605	1	13	6	23	427
Precinct 41	3,460	3,068	296	52	44	125	1,874
Precinct 42 & 42A	4,611	4,142	365	60	44	215	3,011
Precinct 43 & 43A	4,822	4,495	119	129	79	160	2,845
Precinct 50	2,047	1,455	530	37	25	70	1,006
<b>St. Bernard</b>	<b>53,336</b>	<b>48,915</b>	<b>2,224</b>	<b>1,106</b>	<b>1,091</b>	<b>2,479</b>	<b>33,105</b>
* St. Charles							
Precinct 1-1	797	59	731	0	7	5	438
Precinct 1-2	1,616	849	754	3	10	12	1,065
Precinct 1-3	1,188	498	680	3	7	20	703
Precinct 1-5	842	5	835	0	2	7	331

## Assigned Districts - Splits

Total Population Ethnic Breakout  
Plan: Congressional Consensus Plan B

	Tot Pop	Tot White	Tot Black	Tot Asian	Tot Other	Tot Hispanic	Reg Total
Precinct 46	312	61	245	4	2	4	257
Precinct 47	1,789	138	1,633	2	16	39	1,093
Precinct 48	289	192	94	0	3	1	194
Precinct 49	718	430	275	1	12	11	487
Precinct 50	1,227	501	718	0	8	8	629
Precinct 51	1,653	130	1,521	1	1	7	998
Precinct 52	624	548	68	4	4	4	514
Precinct 53	844	573	246	0	25	30	572
Precinct 54	1,271	573	678	8	12	19	791
Precinct 55	1,532	507	1,018	0	7	12	990
<b>Ascension</b>	<b>21,501</b>	<b>9,605</b>	<b>11,497</b>	<b>74</b>	<b>325</b>	<b>456</b>	<b>12,853</b>
Assumption	23,388	15,710	7,403	75	200	284	14,746
Iberia	73,266	47,682	22,926	1,586	1,072	1,101	43,094
* Jefferson							
Precinct 248	284	277	0	0	7	2	179
Precinct 249	1,292	1,213	21	15	43	26	686
Precinct 1-GI	1,541	1,480	4	5	52	23	1,051
Precinct 1-L	2,137	1,988	19	44	86	40	1,239
<b>Jefferson</b>	<b>5,254</b>	<b>4,958</b>	<b>44</b>	<b>64</b>	<b>188</b>	<b>91</b>	<b>3,155</b>
* Lafayette							
Precinct 84	1,697	1,622	40	24	11	18	1,217
Precinct 85	3,153	2,933	105	86	29	83	1,853
Precinct 87	2,810	2,666	59	68	17	67	1,802
Precinct 88	1,290	1,238	41	8	3	23	968
Precinct 89	874	857	6	10	1	22	719
Precinct 91	2,499	2,283	147	44	25	35	1,388
Precinct 92	2,597	2,014	521	26	36	59	1,474
Precinct 93	2,405	1,918	395	33	59	84	1,171
Precinct 94	1,905	1,623	179	67	36	37	1,109
Precinct 95	2,948	2,666	198	47	37	63	1,727
Precinct 96	3,563	3,068	394	41	60	73	1,806
Precinct 97	2,241	2,012	179	20	30	42	1,381
Precinct 98	1,938	1,732	172	15	19	29	1,101
Precinct 99	2,068	1,239	786	4	39	34	1,174
Precinct 100	1,463	1,352	81	14	16	22	957
Precinct 101	2,124	2,015	73	16	20	39	1,389
Precinct 102	2,111	1,863	202	2	44	55	928
Precinct 103	1,605	1,206	384	5	10	10	992
Precinct 104	2,921	2,717	131	38	35	47	1,797
Precinct 105	3,494	3,352	72	27	43	46	1,994
Precinct 106	1,992	1,825	151	7	9	22	1,176
Precinct 107	3,400	3,145	183	22	50	62	1,952

# Assigned Districts - Splits



## Total Population Ethnic Breakout Plan: Congressional Consensus Plan B

DB: GEO\_LA\_HSE

Plan Type: Congress7

	Tot Pop	Tot White	Tot Black	Tot Asian	Tot Other	Tot Hispanic	Reg Total
Precinct 16-9	1,478	492	949	25	12	28	594
Precinct 17-2	659	237	412	0	10	22	363
Precinct 17-3	1,143	102	1,024	12	5	22	546
Precinct 17-4	648	189	452	1	6	10	410
Precinct 17-5	1,097	272	792	18	15	19	618
Precinct 17-6	1,541	15	1,506	3	17	20	724
Precinct 17-7	1,116	317	781	7	11	16	620
Precinct 17-8	1,181	96	1,054	15	16	24	544
Precinct 17-9	1,212	47	1,144	0	21	26	762
Precinct 17-10	913	245	659	1	8	17	535
Precinct 17-11	1,277	24	1,251	1	1	11	843
Precinct 17-12	1,062	72	968	10	12	21	547
Precinct 17-13	1,199	11	1,180	6	2	12	701
Precinct 17-13A	996	3	990	1	2	3	704
Precinct 17-14	1,870	74	1,766	13	17	51	881
Precinct 17-15	682	74	602	2	4	13	667
Precinct 17-16	1,473	57	1,403	1	12	21	776
ZZZZZ	0	0	0	0	0	0	0
<b>Orleans</b>	<b>448,379</b>	<b>103,294</b>	<b>326,809</b>	<b>11,157</b>	<b>7,119</b>	<b>13,366</b>	<b>236,148</b>
<b>* St. Bernard</b>							
Precinct 44	2,126	536	1,559	11	20	65	1,018
Precinct 51	1,027	855	146	6	20	72	743
Precinct 52	3,338	2,419	837	21	61	167	1,964
Precinct 53	474	464	1		8	36	165
Precinct 54	2,178	1,901	204	25	48	107	1,175
Precinct 55	2,941	2,628	187	7	119	226	1,838
Precinct 56	1,084	924	126	5	29	127	226
Precinct 57	264	262	0	0	2	90	237
Precinct 58	461	452	2	3	4	56	526
<b>St. Bernard</b>	<b>13,893</b>	<b>10,441</b>	<b>3,062</b>	<b>79</b>	<b>311</b>	<b>946</b>	<b>7,892</b>
<b>District 2</b>	<b>638,243</b>	<b>195,199</b>	<b>411,996</b>	<b>18,011</b>	<b>13,637</b>	<b>24,177</b>	<b>335,388</b>
<b>District 3</b>							
<b>* Ascension</b>							
Precinct 30	1,133	857	231	5	40	62	663
Precinct 31	1,380	1,024	326	7	23	41	743
Precinct 32	2,311	1,851	366	17	77	107	1,441
Precinct 36	1,571	506	1,023	6	36	46	851
Precinct 37	2,188	670	1,479	12	27	28	1,061
Precinct 38	45	11	30	0	4	0	23
Precinct 39	432	132	288	0	12	9	283
Precinct 40	1,632	782	837	7	6	14	986
Precinct 45	550	119	421	0	10	14	277

**Assigned Districts - Splits****Total Population Ethnic Breakout  
Plan: Congressional Consensus Plan B**

	Tot Pop	Tot White	Tot Black	Tot Asian	Tot Other	Tot Hispanic	Reg Total
Precinct 15-6	1,390	129	1,234	10	17	24	707
Precinct 15-8	773	65	698	0	10	16	455
Precinct 15-9	1,289	167	1,096	15	11	21	666
Precinct 15-10	1,609	55	1,534	0	20	43	965
Precinct 15-11	2,165	12	2,151	0	2	2	939
Precinct 15-12	660	150	503	1	6	7	406
Precinct 15-12A	1,243	142	1,075	7	19	31	778
Precinct 15-13	1,607	315	1,249	5	38	76	629
Precinct 15-13A	941	292	609	23	17	45	540
Precinct 15-13B	2,751	110	2,388	116	137	214	1,237
Precinct 15-14	822	490	266	38	28	47	571
Precinct 15-14A	676	355	287	25	9	27	417
Precinct 15-14B	855	480	349	18	8	31	570
Precinct 15-14C	1,151	638	404	28	81	110	515
Precinct 15-14D	1,201	477	619	39	66	92	395
Precinct 15-14E	2,580	359	1,973	37	211	290	924
Precinct 15-14F	629	370	250	4	5	20	428
Precinct 15-14G	4,013	808	3,065	58	82	132	1,191
Precinct 15-15	2,328	722	1,532	27	47	110	890
Precinct 15-15A	1,239	836	361	17	25	56	645
Precinct 15-15B	766	597	143	9	17	46	492
Precinct 15-16	1,137	601	496	28	12	38	822
Precinct 15-17	1,076	962	68	40	6	39	748
Precinct 15-17A	1,043	844	165	7	27	44	668
Precinct 15-17B	941	775	104	24	38	77	678
Precinct 15-18	712	571	81	42	18	31	512
Precinct 15-18A	1,152	899	147	89	17	33	678
Precinct 15-18B	2,269	628	1,531	60	50	87	1,005
Precinct 15-18C	1,142	979	101	37	25	38	815
Precinct 15-18D	4,700	1,571	2,786	213	130	226	1,533
Precinct 15-18E	1,510	1,140	213	128	29	83	938
Precinct 15-18F	1,334	889	359	67	19	47	900
Precinct 15-19	1,078	8	1,062	6	2	1	838
Precinct 15-19B	838	19	801	6	12	13	616
Precinct 15-19C	2,609	56	1,901	644	8	31	1,346
Precinct 16-1	644	274	354	7	9	20	330
Precinct 16-1A	569	249	280	26	14	30	326
Precinct 16-3	974	729	202	30	13	47	560
Precinct 16-4	1,091	666	376	21	28	51	583
Precinct 16-5	764	605	121	20	18	43	427
Precinct 16-6	1,377	460	877	24	16	26	693
Precinct 16-7	766	606	91	27	42	48	439
Precinct 16-8	724	603	67	40	14	34	465

Date: Sep 12, 2001

Time: 2:01 PM

DB: GEO\_LA\_HSE

Plan Type: Congress7

# Assigned Districts - Splits

## Total Population Ethnic Breakout Plan: Congressional Consensus Plan B



	Tot Pop	Tot White	Tot Black	Tot Asian	Tot Other	Tot Hispanic	Reg Total
Precinct 12-16	1,243	63	1,157	10	13	40	685
Precinct 12-17	763	33	718	0	12	15	432
Precinct 12-18	960	118	827	5	10	33	664
Precinct 12-19	677	10	667	0	0	10	372
Precinct 12-20	1,023	12	1,003	4	4	11	637
Precinct 13-2	873	353	501	4	15	49	503
Precinct 13-3	786	392	371	8	15	31	456
Precinct 13-4	995	606	359	12	18	30	696
Precinct 13-5	958	455	468	20	15	36	580
Precinct 13-6	656	469	164	7	16	16	392
Precinct 13-7	621	465	122	17	17	20	362
Precinct 13-8	820	681	108	11	20	39	543
Precinct 13-9	918	685	205	7	21	45	547
Precinct 13-10	623	588	18	10	7	13	461
Precinct 13-11	1,027	195	810	6	16	21	589
Precinct 13-12	815	187	601	11	16	33	526
Precinct 13-13	863	122	720	6	15	14	505
Precinct 13-14	640	57	575	0	8	4	355
Precinct 13-14A	943	157	762	3	21	26	462
Precinct 13-15	798	441	326	11	20	29	507
Precinct 13-16	941	587	312	15	27	45	617
Precinct 14-5	790	734	31	8	17	34	477
Precinct 14-6	824	771	29	12	12	24	607
Precinct 14-7	792	761	5	19	7	16	550
Precinct 14-12	1,064	940	40	48	36	56	586
Precinct 14-13A	2,539	2,128	228	113	70	150	1,573
Precinct 14-14	578	563	7	6	2	11	546
Precinct 14-15	671	625	20	17	9	22	476
Precinct 14-16	1,306	1,199	37	33	37	73	753
Precinct 14-17	799	722	20	37	20	36	471
Precinct 14-18A	1,240	1,076	59	83	22	58	661
Precinct 14-19	908	715	138	39	16	62	415
Precinct 14-20	547	497	19	24	7	25	574
Precinct 14-21	1,049	724	179	87	59	78	553
Precinct 14-22	928	793	97	27	11	58	347
Precinct 14-23	942	199	715	4	24	40	592
Precinct 14-24A	1,340	682	634	15	9	71	630
Precinct 14-25	712	285	414	4	9	13	442
Precinct 14-26	1,283	24	1,253	2	4	26	662
Precinct 15-1	630	532	61	14	23	38	380
Precinct 15-2	1,373	800	529	10	34	61	738
Precinct 15-3	679	492	168	8	11	19	380
Precinct 15-5	724	90	626	6	2	3	383

Date: Sep 12, 2001

Time: 2:01 PM

DB: GEO\_LA\_HSE

Plan Type: Congress7

# Assigned Districts - Splits

## Total Population Ethnic Breakout Plan: Congressional Consensus Plan B



	Tot Pop	Tot White	Tot Black	Tot Asian	Tot Other	Tot Hispanic	Reg Total
Precinct 9-44P	2,467	108	2,251	98	10	27	1,248
Precinct 9-44Q	1,957	103	1,704	87	63	110	909
Precinct 9-45	1,128	988	71	58	11	31	648
Precinct 9-45A	743	738	1	1	3	5	367
Precinct 10-3	1,134	42	1,092	0	0	4	388
Precinct 10-5	1,332	45	1,256	3	28	30	321
Precinct 10-6	1,205	185	1,001	7	12	54	601
Precinct 10-7	819	490	288	24	17	66	376
Precinct 10-8	659	534	87	14	24	48	377
Precinct 10-9	1,110	838	176	27	69	96	537
Precinct 10-11	1,239	419	754	38	28	67	567
Precinct 10-12	1,090	14	1,068	3	5	10	565
Precinct 10-13	1,381	5	1,371	2	3	14	722
Precinct 10-14	904	4	895	3	2	8	490
Precinct 11-2	1,342	145	1,183	1	13	25	664
Precinct 11-3	723	114	597	2	10	12	378
Precinct 11-4	860	294	549	2	15	29	394
Precinct 11-5	1,273	608	613	8	44	93	740
Precinct 11-8	669	611	25	10	23	28	410
Precinct 11-9	1,339	1,227	64	12	36	75	842
Precinct 11-10	1,296	648	576	35	37	48	702
Precinct 11-11	1,273	30	1,231	4	8	21	602
Precinct 11-12	907	22	884	0	1	2	464
Precinct 11-13	1,043	9	1,029	1	4	5	459
Precinct 11-14	1,470	4	1,462	1	3	9	772
Precinct 11-15	1,423	4	1,417	1	1	7	545
Precinct 11-16	701	2	698		0	3	476
Precinct 11-17	772	8	762	0	2	2	346
Precinct 11-18	696	5	686	0	5	7	389
Precinct 11-19	579	15	561	2	1	3	275
Precinct 12-1	814	369	423	3	19	43	441
Precinct 12-2	796	214	573	2	7	23	403
Precinct 12-3	944	182	750	8	4	25	495
Precinct 12-5	809	694	87	11	17	41	453
Precinct 12-6	612	456	132	6	18	35	416
Precinct 12-7	957	718	197	21	21	35	410
Precinct 12-8	864	639	193	20	12	40	352
Precinct 12-9	920	308	574	18	20	27	496
Precinct 12-10	812	638	114	43	17	38	455
Precinct 12-11	1,319	332	970	8	9	7	677
Precinct 12-12	868	190	663	8	7	19	522
Precinct 12-13	893	9	878	4	2	12	479
Precinct 12-14	1,425	151	1,246	3	25	43	884



Date: Sep 12, 2001

Time: 2:01 PM

# Assigned Districts - Splits



## Total Population Ethnic Breakout Plan: Congressional Consensus Plan B

DB: GEO\_LA\_HSE

Plan Type: Congress7

Page: 15 of 30

	Tot Pop	Tot White	Tot Black	Tot Asian	Tot Other	Tot Hispanic	Reg Total
Precinct 9-39B	761	161	589	9	2	11	458
Precinct 9-40	1,075	232	814	19	10	13	722
Precinct 9-40A	1,149	234	890	23	2	3	667
Precinct 9-40B	724	201	434	83	6	19	419
Precinct 9-40C	1,007	195	719	83	10	20	563
Precinct 9-41	2,785	224	2,054	475	32	72	1,186
Precinct 9-41A	1,585	47	551	959	28	132	452
Precinct 9-41B	4,192	62	2,813	1,289	28	55	1,297
Precinct 9-41C	3,283	159	1,598	1,512	14	22	1,016
Precinct 9-41D	1,239	62	505	671	1	24	584
Precinct 9-42	804	157	639	0	8	11	500
Precinct 9-42A	821	141	665	5	10	8	520
Precinct 9-42B	1,096	155	898	6	37	37	517
Precinct 9-42C	1,231	305	912	8	6	21	530
Precinct 9-42D	826	318	490	4	14	14	531
Precinct 9-42E	1,381	89	1,268	17	7	13	594
Precinct 9-43A	1,813	270	1,526	4	13	31	799
Precinct 9-43B	2,108	24	2,070	8	6	33	804
Precinct 9-43C	1,366	165	1,134	37	30	29	521
Precinct 9-43D	1,599	78	1,508	12	1	14	952
Precinct 9-43E	1,535	123	1,370	18	24	31	619
Precinct 9-43F	961	223	724	4	10	10	632
Precinct 9-43G	1,015	101	900	6	8	10	644
Precinct 9-43H	1,838	23	1,797	3	15	29	464
Precinct 9-43I	961	189	738	26	8	23	633
Precinct 9-43J	1,021	72	925	2	22	3	562
Precinct 9-43K	1,377	205	1,128	2	42	19	697
Precinct 9-43L	1,324	175	1,142	3	4	22	597
Precinct 9-43M	2,966	44	2,896	1	25	18	1,020
Precinct 9-43N	2,420	73	2,319	17	11	17	1,016
Precinct 9-44	2,357	149	2,131	62	15	43	1,234
Precinct 9-44A	1,242	376	819	12	35	40	624
Precinct 9-44B	3,192	175	2,959	18	40	54	1,114
Precinct 9-44D	1,768	308	1,439	9	12	27	950
Precinct 9-44E	2,408	231	2,118	25	34	19	1,258
Precinct 9-44F	1,576	68	1,478	20	10	21	742
Precinct 9-44G	2,285	50	2,224	3	8	24	1,113
Precinct 9-44I	1,476	51	1,260	140	25	16	922
Precinct 9-44J	1,328	376	939	8	5	19	782
Precinct 9-44L	1,651	95	1,503	46	7	16	937
Precinct 9-44M	1,556	280	1,091	157	28	21	1,028
Precinct 9-44N	1,264	37	1,213	14	0	8	773
Precinct 9-44O	2,387	106	2,261	4	16	45	1,204

Date: Sep 12, 2001

Time: 2:01 PM

DB: GEO\_LA\_HSE

Plan Type: Congress7

# Assigned Districts - Splits

## Total Population Ethnic Breakout Plan: Congressional Consensus Plan B



Page: 14 of 30

	Tot Pop	Tot White	Tot Black	Tot Asian	Tot Other	Tot Hispanic	Reg Total
Precinct 9-21	1,348	29	1,308	0	11	14	745
Precinct 9-22	1,434	16	1,411	0	7	17	794
Precinct 9-23	1,234	9	1,223	1	1	11	793
Precinct 9-24	1,023	46	969	4	4	31	443
Precinct 9-25	819	1	817	0	1	6	528
Precinct 9-25A	782	6	775	1	0	5	609
Precinct 9-26	413	3	409	1	0	5	338
Precinct 9-26A	2,037	4	2,027	0	6	17	821
Precinct 9-27	832	6	819	0	7	14	477
Precinct 9-28	712	8	700	0	4	8	444
Precinct 9-28A	592	0	591	1	0	1	278
Precinct 9-28C	666	3	653	0	10	13	481
Precinct 9-28D	529	0	529	0	0	1	396
Precinct 9-28E	366	0	362	4	0	2	383
Precinct 9-28F	721	3	716	0	2	4	474
Precinct 9-29	865	130	714	8	13	25	363
Precinct 9-29A	592	356	214	11	11	13	356
Precinct 9-30	633	71	543	2	17	12	477
Precinct 9-30A	1,460	514	846	86	14	34	701
Precinct 9-31	915	124	750	20	21	43	640
Precinct 9-31A	787	66	716	4	1	3	553
Precinct 9-31B	752	3	743	1	5	3	748
Precinct 9-31C	729	4	717	1	7	4	552
Precinct 9-31D	505	9	493	0	3	5	524
Precinct 9-31E	644	8	617	1	18	10	626
Precinct 9-32	1,593	187	1,331	31	44	63	587
Precinct 9-33	1,119	47	1,056	3	13	7	584
Precinct 9-33A	1,021	54	960	1	6	5	581
Precinct 9-34	876	31	837	1	7	6	482
Precinct 9-34A	2,482	12	2,453	5	12	15	1,279
Precinct 9-35	1,654	61	1,582	1	10	19	908
Precinct 9-35A	1,193	29	1,159	3	2	12	681
Precinct 9-36	768	89	669	1	9	14	466
Precinct 9-36A	967	110	846	3	8	13	559
Precinct 9-36B	1,479	17	1,451	1	10	19	841
Precinct 9-36C	795	78	702	1	14	35	487
Precinct 9-37	689	140	540	0	9	27	366
Precinct 9-37A	752	158	583	7	4	8	462
Precinct 9-38	794	113	663	14	4	13	504
Precinct 9-38A	587	130	449	2	6	22	335
Precinct 9-38B	694	100	581	6	7	11	436
Precinct 9-39	1,153	188	939	16	10	23	670
Precinct 9-39A	699	120	575	0	4	22	429

Date: Sep 12, 2001

Time: 2:01 PM

DB: GEO\_LA\_HSE

Plan Type: Congress7

# Assigned Districts - Splits

## Total Population Ethnic Breakout Plan: Congressional Consensus Plan B



	Tot Pop	Tot White	Tot Black	Tot Asian	Tot Other	Tot Hispanic	Reg Total
Precinct 8-19	1,018	176	826	1	15	24	573
Precinct 8-20	1,009	208	788	3	10	50	547
Precinct 8-21	839	366	443	14	16	19	502
Precinct 8-22	722	387	319	2	14	29	476
Precinct 8-23	866	369	451	7	39	34	508
Precinct 8-24	850	316	508	10	16	36	490
Precinct 8-25	643	215	417	2	9	34	396
Precinct 8-25A	740	178	549	0	13	20	396
Precinct 8-26	634	214	403	1	16	44	396
Precinct 8-26A	794	109	666	2	17	17	591
Precinct 8-27	607	192	397	6	12	41	402
Precinct 8-27A	833	54	765	3	11	11	565
Precinct 8-28	1,237	681	500	33	23	54	915
Precinct 8-29	1,165	240	894	12	19	60	509
Precinct 8-30	962	83	849	7	23	30	565
Precinct 9-1	1,593	239	1,326	11	17	27	691
Precinct 9-2	1,206	193	992	3	18	26	526
Precinct 9-3A	970	1	966	0	3	5	719
Precinct 9-3B	986	7	978	0	1	11	548
Precinct 9-3	781	7	772	0	2	4	557
Precinct 9-4	1,167	38	1,114	1	14	17	613
Precinct 9-5	1,190	11	1,175	1	3	14	657
Precinct 9-5A	1,430	14	1,410	0	6	4	706
Precinct 9-6B	1,272	2	1,268	0	2	0	837
Precinct 9-6C	1,212	5	1,206	0	1	5	849
Precinct 9-6D	970	1	966	0	3	3	761
Precinct 9-6E	981	1	974	1	5	3	619
Precinct 9-6F	938	1	935	1	1	1	635
Precinct 9-7	1,541	73	1,456	1	11	9	809
Precinct 9-8	1,087	13	1,069	3	2	10	769
Precinct 9-8A	1,094	3	1,090	1	0	6	957
Precinct 9-8B	1,097	7	1,076	12	2	4	544
Precinct 9-9	959	245	689	13	12	65	418
Precinct 9-10	1,266	118	1,131	6	11	21	619
Precinct 9-11	667	282	359	6	20	37	302
Precinct 9-12	859	446	394	2	17	40	455
Precinct 9-13	597	416	164	2	15	47	343
Precinct 9-14	976	279	654	14	29	50	401
Precinct 9-15	993	295	683	7	8	26	477
Precinct 9-16	993	237	740	2	14	20	461
Precinct 9-17	1,484	47	1,421	0	16	13	739
Precinct 9-18	994	41	952	0	1	13	467
Precinct 9-19	1,882	115	1,753	3	11	28	767

Date: Sep 12, 2001

Time: 2:01 PM

DB: GEO\_LA\_HSE

Plan Type: Congress7

# Assigned Districts - Splits

## Total Population Ethnic Breakout Plan: Congressional Consensus Plan B



	Tot Pop	Tot White	Tot Black	Tot Asian	Tot Other	Tot Hispanic	Reg Total
Precinct 7-20A	890	15	849	1	25	28	452
Precinct 7-21	1,200	48	1,139	2	11	26	623
Precinct 7-22	746	64	662	1	19	26	430
Precinct 7-23	1,733	122	1,585	1	25	71	907
Precinct 7-24	929	93	828	5	3	10	1,584
Precinct 7-25	1,157	32	1,100	9	16	10	1,006
Precinct 7-25A	963	210	731	3	19	30	666
Precinct 7-26	646	35	607	0	4	6	385
Precinct 7-26A	905	15	880	1	9	9	634
Precinct 7-27	3,262	6	3,254	0	2	22	1,271
Precinct 7-27A	810	8	801	0	1	4	539
Precinct 7-27B	1,658	6	1,652	0	0	12	855
Precinct 7-28	1,279	64	1,202	6	7	17	730
Precinct 7-28A	1,020	13	995	0	12	34	579
Precinct 7-29	811	64	729	4	14	22	689
Precinct 7-30	921	114	792	9	6	9	752
Precinct 7-31	655	201	449	3	2	12	469
Precinct 7-32	797	501	243	32	21	30	595
Precinct 7-33	495	279	213	0	3	35	383
Precinct 7-34	664	74	578	1	11	14	322
Precinct 7-35	788	180	578	7	23	43	429
Precinct 7-36	781	227	529	7	18	38	436
Precinct 7-36A	571	170	371	2	28	34	335
Precinct 7-37	652	284	337	21	10	37	371
Precinct 7-37A	1,209	572	407	186	44	92	485
Precinct 7-38A	1,148	452	641	22	33	66	502
Precinct 7-39	520	344	159	7	10	26	388
Precinct 8-1	678	573	79	6	20	31	431
Precinct 8-2	841	563	204	17	57	76	454
Precinct 8-4	877	123	735	3	16	56	403
Precinct 8-6	1,647	120	1,487	7	33	104	720
Precinct 8-7	972	29	939	1	3	16	402
Precinct 8-8	1,183	52	1,109	13	9	29	510
Precinct 8-9	1,043	17	1,019	0	7	21	539
Precinct 8-10	998	31	960	0	7	7	434
Precinct 8-11	805	12	786	0	7	15	441
Precinct 8-12	1,107	32	1,062	3	10	21	600
Precinct 8-13	1,170	39	1,116	1	14	28	756
Precinct 8-14	822	38	763	0	21	51	410
Precinct 8-15	1,238	176	1,046	6	10	21	674
Precinct 8-16	624	78	523	9	14	20	349
Precinct 8-17	896	163	724	4	5	11	477
Precinct 8-18	1,097	166	912	4	15	21	505

Date: Sep 12, 2001

Time: 2:01 PM

# Assigned Districts - Splits



DB: GEO\_LA\_HSE

## Total Population Ethnic Breakout Plan: Congressional Consensus Plan B

Plan Type: Congress7

Page: 11 of 30

	Tot Pop	Tot White	Tot Black	Tot Asian	Tot Other	Tot Hispanic	Reg Total
Precinct 5-2	539	490	22	12	15	13	379
Precinct 5-3	831	772	43	4	12	20	493
Precinct 5-4	275	7	264	1	3	0	237
Precinct 5-5	1,278	2	1,272	0	4	14	613
Precinct 5-6	905	6	898	0	1	6	483
Precinct 5-7	2,240	20	2,199	0	21	11	987
Precinct 5-8	1,149	57	1,059	0	33	51	546
Precinct 5-9	913	33	876	0	4	10	433
Precinct 5-10	779	44	728	0	7	5	410
Precinct 5-11	701	194	478	6	23	42	323
Precinct 5-12	768	461	267	12	28	48	388
Precinct 5-13	648	608	18	14	8	20	398
Precinct 5-14	683	531	97	9	46	72	357
Precinct 5-15	645	584	42	10	9	15	395
Precinct 6-1	873	806	29	18	20	19	593
Precinct 6-2	996	832	125	11	28	31	630
Precinct 6-4	904	184	702	0	18	15	540
Precinct 6-5	804	40	758	1	5	16	397
Precinct 6-6	1,048	62	963	1	22	41	529
Precinct 6-7	855	80	768	2	5	15	455
Precinct 6-8	778	360	375	20	23	22	450
Precinct 6-9	942	678	206	28	30	34	583
Precinct 7-1	1,171	912	219	15	25	69	652
Precinct 7-2	998	438	531	7	22	20	471
Precinct 7-4	1,073	67	972	5	29	52	490
Precinct 7-4A	903	4	897	1	1	21	423
Precinct 7-5	1,240	19	1,216	3	2	12	593
Precinct 7-6	1,250	87	1,150	0	13	22	582
Precinct 7-7	1,449	20	1,412	4	13	35	650
Precinct 7-8	1,227	15	1,196	0	16	4	644
Precinct 7-9	922	4	916	0	2	0	479
Precinct 7-9A	894	10	859	0	25	16	517
Precinct 7-10	979	1	965	1	12	33	516
Precinct 7-11	1,310	58	1,237	1	14	27	709
Precinct 7-12	1,131	407	708	4	12	28	610
Precinct 7-13	1,120	25	1,081	0	14	21	615
Precinct 7-14	1,210	32	1,158	5	15	18	664
Precinct 7-15	1,186	93	1,085	0	8	27	624
Precinct 7-16	981	72	896	3	10	23	502
Precinct 7-17	936	497	409	4	26	58	456
Precinct 7-18	1,487	651	795	7	34	34	884
Precinct 7-19	646	137	489	0	20	25	429
Precinct 7-20	1,306	18	1,258	1	29	35	728

## Assigned Districts - Splits

Total Population Ethnic Breakout  
Plan: Congressional Consensus Plan B

	Tot Pop	Tot White	Tot Black	Tot Asian	Tot Other	Tot Hispanic	Reg Total
Precinct 33-K	1,341	158	1,163	0	20	13	818
Precinct 1-W	1,040	529	488	3	20	20	612
Precinct 2-W	863	159	691	7	6	12	505
Precinct 3-W	1,430	1,316	70	4	40	36	951
Precinct 4-W	953	858	56	7	32	42	652
Precinct 5-W	2,088	1,719	307	7	55	65	1,405
Precinct 6-W	2,198	1,717	272	121	88	125	1,114
Precinct 7-W	2,025	1,666	279	40	40	86	1,250
<b>Jefferson</b>	<b>175,971</b>	<b>81,464</b>	<b>82,125</b>	<b>6,775</b>	<b>5,607</b>	<b>9,865</b>	<b>91,348</b>
* Orleans							
Precinct 1-1	562	138	400	6	18	20	340
Precinct 1-2	698	347	325	6	20	36	429
Precinct 1-5	1,048	773	213	17	45	87	614
Precinct 1-6	691	45	640	2	4	3	421
Precinct 1-7	494	1	463	0	30	9	279
Precinct 2-1	1,253	917	281	35	20	74	569
Precinct 2-2	698	358	307	21	12	26	872
Precinct 2-3	312	35	272	0	5	9	196
Precinct 2-4	1,830	21	1,803	4	2	10	943
Precinct 2-6	1,638	4	1,631	0	3	19	982
Precinct 2-6A	2,701	10	2,686	0	5	19	763
Precinct 2-7	2,172	45	2,115	9	3	16	1,956
Precinct 3-1	1,210	748	320	104	38	48	686
Precinct 3-3	1,071	420	438	192	21	27	237
Precinct 3-5	924	131	764	13	16	24	398
Precinct 3-8	7,093	713	6,265	82	33	151	501
Precinct 3-9	1,524	217	1,171	26	110	192	624
Precinct 3-10	1,241	377	738	11	115	209	422
Precinct 3-12	1,347	353	861	44	89	164	512
Precinct 3-14	717	360	275	11	71	125	367
Precinct 3-15	972	194	733	13	32	52	429
Precinct 3-16	554	157	360	1	36	78	391
Precinct 3-18	1,294	233	926	36	99	164	380
Precinct 3-19	1,541	761	589	28	163	302	684
Precinct 3-20	774	490	243	6	35	121	390
Precinct 4-2	3,144	567	2,559	9	9	34	1,203
Precinct 4-3	940	4	936	0	0	2	423
Precinct 4-4	1,045	54	920	7	64	91	464
Precinct 4-5	782	155	559	1	67	111	300
Precinct 4-6	517	262	191	4	60	127	203
Precinct 4-7	559	318	191	13	37	66	281
Precinct 4-8	804	686	75	12	31	53	420
Precinct 5-1	573	543	12	9	9	18	356

Date: Sep 12, 2001

Time: 2:01 PM

DB: GEO\_LA\_HSE

Plan Type: Congress7

# Assigned Districts - Splits

## Total Population Ethnic Breakout Plan: Congressional Consensus Plan B



	Tot Pop	Tot White	Tot Black	Tot Asian	Tot Other	Tot Hispanic	Reg Total
Precinct 196	3,891	991	2,504	236	160	252	1,686
Precinct 197	3,437	622	2,645	121	49	158	1,668
Precinct 198	1,165	1,020	95	7	43	73	702
Precinct 199	1,736	1,309	313	48	66	113	943
Precinct 200	1,475	9	1,464	0	2	8	1,033
Precinct 201	2,630	17	2,602	0	11	20	1,512
Precinct 202	1,309	1,007	199	58	45	72	752
Precinct 203	1,557	1,271	163	24	99	124	818
Precinct 205	2,402	596	1,576	178	52	93	1,219
Precinct 212	1,916	121	1,765	25	5	15	1,298
Precinct 213A	1,198	149	998	38	13	34	433
Precinct 213B	1,645	1,083	322	179	61	187	988
Precinct 213C	2,690	296	2,210	68	116	152	708
Precinct 214	5,235	1,426	3,242	310	257	353	1,604
Precinct 215	2,641	1,860	567	167	47	104	1,766
Precinct 216	4,999	1,879	2,652	359	109	257	2,172
Precinct 217	3,333	1,951	918	366	98	130	1,735
Precinct 232	5,511	1,811	3,235	280	185	314	2,058
Precinct 233	633	593	10	24	6	30	514
Precinct 235	1,388	1,069	202	89	28	73	1,100
Precinct 236	3,063	1,698	946	168	251	351	1,386
Precinct 237	2,923	1,751	931	133	108	161	1,604
Precinct 238	3,432	2,124	897	319	92	201	1,508
Precinct 246	1,074	881	56	23	114	63	605
Precinct 247	1,333	1,159	150	5	19	25	839
Precinct 1-G	520	358	130	18	14	12	296
Precinct 2-G	960	598	329	6	27	22	504
Precinct 4-G	819	262	541	2	14	24	541
Precinct 6-G	934	310	583	18	23	25	564
Precinct 7-G	2,019	585	1,371	18	45	78	1,239
Precinct 8-G	1,417	755	450	126	86	139	865
Precinct 11-G	3,199	1,517	1,392	130	160	249	1,562
Precinct 13-KB	2,009	750	977	17	265	559	522
Precinct 14-K	3,530	2,553	558	113	306	738	1,845
Precinct 15-K	1,604	1,105	336	34	129	219	818
Precinct 21-K	1,086	202	826	8	50	126	617
Precinct 22-K	1,080	13	1,051	0	16	23	643
Precinct 23-K	3,610	913	2,536	40	121	237	1,111
Precinct 24-K	1,903	229	1,622	3	49	95	506
Precinct 26-K	1,628	738	788	17	85	128	756
Precinct 29-K	1,725	1,249	355	20	101	165	982
Precinct 30-K	1,002	604	345	13	40	73	534
Precinct 31-K	902	119	769	0	14	22	484

# Assigned Districts - Splits

## Total Population Ethnic Breakout Plan: Congressional Consensus Plan B



	Tot Pop	Tot White	Tot Black	Tot Asian	Tot Other	Tot Hispanic	Reg Total
Precinct 125	2,032	1,274	731	14	13	20	969
Precinct 127	1,728	1,129	511	26	62	69	735
Precinct 129	2,606	676	1,900	2	28	32	1,381
Precinct 133	2,561	2,121	390	7	43	39	1,172
<b>Tangipahoa</b>	<b>69,721</b>	<b>44,275</b>	<b>24,181</b>	<b>379</b>	<b>886</b>	<b>1,174</b>	<b>37,079</b>
Washington	43,926	29,614	13,943	100	269	334	25,126
<b>District 1</b>	<b>638,385</b>	<b>521,299</b>	<b>89,588</b>	<b>11,992</b>	<b>15,506</b>	<b>30,972</b>	<b>367,893</b>
<b>District 2</b>							
* Jefferson							
Precinct 104	1,729	8	1,716	5	0	21	1,061
Precinct 107	246	9	237	0	0	1	162
Precinct 108	945	1	940	0	4	3	586
Precinct 115	1,264	102	1,143	9	10	9	637
Precinct 131	639	131	482	11	15	12	385
Precinct 133	1,037	189	818	9	21	35	594
Precinct 138	621	236	323	10	52	78	269
Precinct 150	2,824	2,006	644	52	122	208	1,486
Precinct 151	2,686	2,051	515	38	82	171	1,285
Precinct 152	1,884	1,113	688	24	59	94	912
Precinct 153	2,092	15	2,062	1	14	14	1,553
Precinct 154	1,989	6	1,973	7	3	3	1,492
Precinct 155	1,271	1,056	172	22	21	32	772
Precinct 156	4,448	1,144	2,916	308	80	160	1,806
Precinct 157	4,168	2,410	959	655	144	229	2,155
Precinct 170	2,072	1,513	447	28	84	122	1,126
Precinct 172	2,686	2,046	532	34	74	108	1,328
Precinct 173	1,695	346	1,305	25	19	19	761
Precinct 174	605	412	167	17	9	25	381
Precinct 179A	2,182	1,396	512	243	31	83	1,307
Precinct 179B	865	94	757	13	1	10	668
Precinct 180	1,609	19	1,583	3	4	3	1,254
Precinct 181	2,203	215	1,980	3	5	24	1,500
Precinct 182	1,473	1,112	297	21	43	51	870
Precinct 187	2,669	124	2,524	5	16	28	1,370
Precinct 188	1,638	322	1,252	28	36	50	873
Precinct 189	3,497	2,504	717	182	94	211	1,840
Precinct 190	2,583	2,187	253	99	44	106	1,674
Precinct 191	4,212	2,208	1,549	294	161	345	1,824
Precinct 192	3,055	2,545	362	42	106	178	1,836
Precinct 193	4,109	2,778	1,004	160	167	361	1,900
Precinct 194	3,205	2,474	481	157	93	182	1,817
Precinct 195	3,269	1,017	1,868	273	111	193	1,517



Date: Sep 12, 2001

Time: 2:01 PM

DB: GEO\_LA\_HSE

Plan Type: Congress7

# Assigned Districts - Splits

## Total Population Ethnic Breakout Plan: Congressional Consensus Plan B



	Tot Pop	Tot White	Tot Black	Tot Asian	Tot Other	Tot Hispanic	Reg Total
Precinct 26	546	252	287	4	3	6	325
Precinct 27	779	477	265	10	27	16	528
Precinct 28	702	574	126	0	2	6	469
Precinct 33	617	535	72	0	10	28	393
Precinct 40	949	747	156	7	39	49	424
Precinct 40A	1,987	1,628	311	26	22	34	866
Precinct 41	2,488	1,894	529	18	47	50	713
Precinct 42	1,308	467	812	13	16	12	593
Precinct 42A	955	718	219	6	12	24	532
Precinct 43	594	78	504	1	11	8	339
Precinct 44	1,565	1,261	270	21	13	17	831
Precinct 45	1,468	1,137	271	54	6	11	890
Precinct 45A	1,973	911	1,020	3	39	63	851
Precinct 46	1,865	175	1,667	16	7	13	1,034
Precinct 47	1,512	331	1,151	18	12	16	837
Precinct 48	642	365	271	2	4	13	319
Precinct 49	1,342	796	528	4	14	25	682
Precinct 101	998	660	326	6	6	5	441
Precinct 102	1,530	1,041	478	0	11	19	839
Precinct 103	386	139	244	0	3	0	229
Precinct 104	907	819	86	2	0	0	575
Precinct 104A	594	431	148	1	14	25	336
Precinct 105	163	90	73	0	0	8	101
Precinct 106	951	658	272	8	13	2	603
Precinct 106A	1,103	971	121	0	11	8	616
Precinct 107	1,170	345	809	7	9	11	621
Precinct 108	859	599	256	1	3	1	515
Precinct 109	944	349	592	0	3	3	561
Precinct 110	1,354	1,190	128	1	35	23	815
Precinct 111	508	332	166	4	6	2	273
Precinct 111A	971	495	450	0	26	30	473
Precinct 112	1,601	1,440	158	0	3	13	836
Precinct 114	1,153	1,113	27	3	10	14	668
Precinct 115B	757	155	600	0	2	4	388
Precinct 116	1,263	973	267	8	15	21	669
Precinct 117	1,826	1,528	235	8	55	111	908
Precinct 118	2,258	1,961	258	10	29	29	1,200
Precinct 119	1,001	791	201	2	7	12	568
Precinct 120	1,507	1,456	18	2	31	42	814
Precinct 120A	2,097	1,977	96	3	21	24	1,250
Precinct 121	610	545	37	1	27	33	344
Precinct 121A	2,058	1,853	154	9	42	45	1,091
Precinct 123	1,969	1,417	515	5	32	34	1,010

# Assigned Districts - Splits

## Total Population Ethnic Breakout

### Plan: Congressional Consensus Plan B



	Tot Pop	Tot White	Tot Black	Tot Asian	Tot Other	Tot Hispanic	Reg Total
Precinct 16-2	1,021	916	51	32	22	62	511
Precinct 17-1	655	460	166	4	25	46	364
Precinct 17-17	755	734	17	4	0	10	559
Precinct 17-18	668	650	2	2	14	10	564
Precinct 17-18A	885	822	30	20	13	44	573
Precinct 17-18B	518	490	9	18	1	26	345
Precinct 17-19	746	699	13	18	16	39	479
Precinct 17-19A	802	761	5	21	15	28	504
Precinct 17-20	810	768	12	8	22	54	493
Precinct 17-21	1,481	1,410	23	22	26	78	828
<b>Orleans</b>	<b>35,148</b>	<b>31,766</b>	<b>2,231</b>	<b>575</b>	<b>576</b>	<b>1,430</b>	<b>23,025</b>
* St. Charles							
Precinct 1-6	2,202	1,490	687	17	8	53	1,055
Precinct 2-7	459	414	36	1	8	18	254
Precinct 2-8	73	64	9	0	0	1	31
Precinct 3-1	3,273	3,049	124	55	45	137	2,011
Precinct 3-2	2,102	1,723	324	23	32	125	1,061
Precinct 3-3	859	798	50	7	4	7	617
Precinct 3-4	1,521	1,322	150	34	15	61	992
Precinct 5-1	1,591	153	1,423	4	11	12	1,009
Precinct 5-2	0	0	0	0	0	0	0
Precinct 5-3	1,207	937	243	15	12	35	648
Precinct 5-4	2,127	1,062	988	20	57	92	1,036
Precinct 5-5	1,600	1,445	79	9	67	157	756
Precinct 6-1	1,120	902	199	6	13	11	574
Precinct 6-2	1,192	567	612	1	12	26	791
Precinct 6-3	1,747	1,688	28	9	22	35	1,157
Precinct 6-4	641	562	54	12	13	11	313
Precinct 6-5	426	170	244	0	12	3	261
Precinct 6-6	929	351	566	1	11	26	547
Precinct 6-7	1,012	909	90	2	11	25	534
<b>St. Charles</b>	<b>24,081</b>	<b>17,606</b>	<b>5,906</b>	<b>216</b>	<b>353</b>	<b>835</b>	<b>13,647</b>
St. Tammany	191,268	166,458	19,620	1,865	3,325	4,737	114,700
Tangipahoa							
Precinct 1	717	366	349	0	2	0	551
Precinct 2	1,267	324	940	2	1	15	831
Precinct 6	747	63	684	0	0	1	350
Precinct 11	1,162	400	758	1	3	16	745
Precinct 15	1,323	642	654	24	3	30	533
Precinct 16	1,073	924	135	10	4	12	756
Precinct 17	1,414	315	1,072	8	19	19	885
Precinct 18	1,261	367	883	1	10	11	801

# Assigned Districts - Splits

## Total Population Ethnic Breakout Plan: Congressional Consensus Plan B



	Tot Pop	Tot White	Tot Black	Tot Asian	Tot Other	Tot Hispanic	Reg Total
Precinct 28-K	1,244	1,126	61	21	36	94	684
Precinct 34-K	2,065	1,727	140	45	153	452	1,016
Precinct 35-K	1,355	1,157	100	79	19	112	667
<b>ZZZZZ</b>	<b>0</b>	<b>0</b>	<b>0</b>	<b>0</b>	<b>0</b>	<b>0</b>	<b>0</b>
<b>Jefferson</b>	<b>274,241</b>	<b>231,580</b>	<b>23,707</b>	<b>8,857</b>	<b>10,097</b>	<b>22,462</b>	<b>154,316</b>
* Orleans							
Precinct 4-9	724	688	14	6	16	38	477
Precinct 4-10	584	508	50	4	22	37	328
Precinct 4-10A	565	542	11	2	10	18	352
Precinct 4-11	1,126	1,036	41	14	35	69	622
Precinct 4-14	1,265	1,239	14	5	7	46	842
Precinct 4-14A	590	565	7	6	12	24	396
Precinct 4-15	725	692	10	4	19	39	377
Precinct 4-16	598	566	15	9	8	26	364
Precinct 4-16A	520	515	2	0	3	20	350
Precinct 4-17	774	753	0	6	15	25	517
Precinct 4-17A	804	789	1	9	5	17	554
Precinct 4-18	806	794	3	3	6	27	576
Precinct 4-18A	776	746	4	14	12	16	521
Precinct 4-19	816	793	10	8	5	38	506
Precinct 4-20	571	544	5	16	6	23	330
Precinct 4-20A	497	479	7	9	2	6	372
Precinct 4-21	584	566	3	5	10	35	343
Precinct 4-21A	458	441	0	10	7	15	309
Precinct 4-22	919	893	6	15	5	29	632
Precinct 4-23	750	704	10	27	9	13	630
Precinct 5-16	596	505	56	16	19	32	328
Precinct 5-17	749	727	0	21	1	21	616
Precinct 5-18	1,197	1,150	13	22	12	35	831
Precinct 7-33A	555	410	119	22	4	26	377
Precinct 7-40	946	710	171	37	28	60	568
Precinct 7-41	501	465	5	28	3	6	372
Precinct 7-42	574	513	35	20	6	30	460
Precinct 12-4	700	315	371	2	12	30	398
Precinct 13-1	646	203	423	1	19	25	403
Precinct 14-1	689	603	51	11	24	28	463
Precinct 14-2	738	557	153	11	17	23	461
Precinct 14-3	704	632	27	24	21	25	407
Precinct 14-4	696	554	122	4	16	18	397
Precinct 14-8	780	741	30	5	4	29	535
Precinct 14-9	812	785	15	7	5	24	600
Precinct 14-10	916	819	76	12	9	29	752
Precinct 14-11	556	514	23	11	8	31	439

**Assigned Districts - Splits****Total Population Ethnic Breakout  
Plan: Congressional Consensus Plan B**

	Tot Pop	Tot White	Tot Black	Tot Asian	Tot Other	Tot Hispanic	Reg Total
Precinct 210	811	565	198	6	42	50	428
Precinct 211	2,048	1,336	616	36	60	100	730
Precinct 225	4,687	1,428	2,935	99	225	363	1,279
Precinct 226	2,902	1,903	722	119	158	296	1,526
Precinct 227	3,030	1,917	772	101	240	432	1,339
Precinct 228	3,034	2,074	680	110	170	323	1,415
Precinct 229	1,280	1,191	29	26	34	92	962
Precinct 230	2,499	2,184	119	82	114	188	1,672
Precinct 231	2,487	1,708	514	187	78	198	1,485
Precinct 234	3,398	2,383	674	158	183	261	1,867
Precinct 3-G	1,779	1,392	268	31	88	89	949
Precinct 5-G	665	573	59	22	11	20	495
Precinct 9-G	2,463	1,597	525	180	161	259	1,097
Precinct 10-G	1,957	1,647	176	37	97	188	1,320
Precinct 1-H	1,648	1,564	43	10	31	52	977
Precinct 2-H	967	941	1	10	15	13	684
Precinct 3-H	1,203	1,149	22	8	24	28	764
Precinct 4-H	1,572	1,543	1	2	26	43	1,086
Precinct 5-H	461	455	0	1	5	8	314
Precinct 6-H	675	668	1	2	4	15	377
Precinct 7-H	908	878	2	6	22	33	630
Precinct 8-H	1,408	1,378	0	10	20	22	1,111
Precinct 9-H	850	834	0	2	14	25	622
Precinct 1-K	1,759	1,534	85	123	17	91	1,173
Precinct 2-K	2,655	2,163	274	156	62	166	1,305
Precinct 3-K	3,128	2,353	401	119	255	590	1,278
Precinct 4-K	3,193	2,440	419	130	204	448	1,418
Precinct 5-K	1,968	1,861	7	94	6	66	1,313
Precinct 6-K	3,818	2,891	548	117	262	613	1,838
Precinct 7-K	3,185	2,410	371	109	295	659	1,587
Precinct 8-K	3,125	2,424	458	150	93	298	1,426
Precinct 9-K	1,091	961	36	65	29	87	667
Precinct 10-K	1,635	1,276	190	95	74	188	807
Precinct 11-K	1,360	1,007	242	30	81	141	686
Precinct 12-K	2,261	2,118	18	109	16	114	1,536
Precinct 13-KA	907	776	78	21	32	62	484
Precinct 16-K	2,156	1,808	100	80	168	460	1,197
Precinct 17-K	2,389	2,030	146	107	106	281	1,228
Precinct 18-K	851	684	88	33	46	195	335
Precinct 19-K	3,572	2,510	258	200	604	1,431	1,481
Precinct 20-K	2,665	2,336	132	88	109	280	1,466
Precinct 25-K	2,704	1,994	488	83	139	362	1,255
Precinct 27-K	1,198	863	240	21	74	106	639

Date: Sep 12, 2001

Time: 2:01 PM

# Assigned Districts - Splits



## Total Population Ethnic Breakout Plan: Congressional Consensus Plan B

DB: GEO\_LA\_HSE

Plan Type: Congress7

Page: 3 of 30

	Tot Pop	Tot White	Tot Black	Tot Asian	Tot Other	Tot Hispanic	Reg Total
Precinct 90	1,086	1,063	3	6	14	30	681
Precinct 91	1,016	983	7	9	17	37	607
Precinct 92	691	688	0	0	3	12	435
Precinct 93	777	761	5	4	7	13	572
Precinct 94	1,104	1,089	1	9	5	28	777
Precinct 95	1,101	1,074	10	12	5	20	779
Precinct 96	490	484	1	4	1	7	334
Precinct 97	752	737	1	5	9	40	540
Precinct 98	1,662	1,622	4	9	27	76	1,213
Precinct 99	897	845	9	19	24	47	467
Precinct 100	452	450	1	1	0	2	355
Precinct 101	440	433	1	4	2	6	293
Precinct 102	772	757	4	7	4	20	535
Precinct 103	919	904	0	7	8	6	722
Precinct 105	558	539	3	4	12	20	388
Precinct 106	903	734	133	4	32	63	553
Precinct 116	1,367	1,037	267	28	35	72	608
Precinct 117	1,705	1,508	152	26	19	44	1,002
Precinct 118	1,248	1,214	14	7	13	31	805
Precinct 119	967	950	1	5	11	33	656
Precinct 120	621	616	1	3	1	5	525
Precinct 121	1,408	1,375	5	14	14	40	1,001
Precinct 122	1,270	1,247	8	4	11	46	963
Precinct 123	2,229	2,181	7	14	27	55	1,536
Precinct 124	2,447	2,364	22	20	41	90	1,535
Precinct 125	3,635	2,822	495	208	110	203	1,254
Precinct 126	1,821	1,644	125	23	29	51	1,030
Precinct 127	1,362	1,249	92	10	11	47	680
Precinct 128	1,606	1,317	237	14	38	83	799
Precinct 129	1,197	1,137	34	7	19	35	702
Precinct 130	884	825	31	7	21	48	491
Precinct 132	729	601	99	4	25	40	470
Precinct 134	1,742	1,249	395	52	46	97	787
Precinct 136	1,357	1,049	203	66	39	105	716
Precinct 171	369	175	153	34	7	16	171
Precinct 175	1,329	1,238	29	21	41	44	846
Precinct 176	621	581	5	17	18	31	413
Precinct 177	962	901	23	8	30	45	634
Precinct 178	1,004	904	63	3	34	37	530
Precinct 183	1,433	1,285	108	7	33	47	689
Precinct 184	2,887	2,558	174	86	69	145	1,863
Precinct 185	1,462	1,185	109	145	23	53	924
Precinct 204	1,534	1,228	179	109	18	47	987

Date: Sep 12, 2001

Time: 2:01 PM

DB: GEO\_LA\_HSE

Plan Type: Congress7

# Assigned Districts - Splits

## Total Population Ethnic Breakout Plan: Congressional Consensus Plan B



	Tot Pop	Tot White	Tot Black	Tot Asian	Tot Other	Tot Hispanic	Reg Total
Precinct 43	1,044	1,005	8	19	12	45	725
Precinct 44	1,790	1,681	8	60	41	68	1,047
Precinct 45	1,990	1,652	75	185	78	169	843
Precinct 46	1,503	1,222	77	136	68	191	636
Precinct 51	2,249	2,141	33	16	59	200	1,316
Precinct 52	2,433	2,284	69	24	56	162	1,493
Precinct 53	1,243	1,172	15	27	29	43	840
Precinct 54	1,237	1,146	32	14	45	84	824
Precinct 55	1,525	1,312	166	11	36	136	855
Precinct 56	1,761	1,557	132	17	55	164	1,003
Precinct 57	2,097	1,289	732	17	59	165	965
Precinct 58	2,290	1,806	209	95	180	365	751
Precinct 59	1,704	1,583	53	27	41	137	983
Precinct 60	2,541	2,426	35	26	54	179	1,744
Precinct 61	1,332	1,265	29	22	16	48	863
Precinct 62	917	902	0	6	9	41	623
Precinct 63	877	836	2	17	22	31	619
Precinct 64	712	681	5	9	17	45	518
Precinct 65	1,264	1,212	14	18	20	78	749
Precinct 66	1,461	1,399	23	9	30	70	1,084
Precinct 67	1,047	616	260	8	163	236	403
Precinct 68	2,101	1,947	54	23	77	119	1,108
Precinct 69	1,039	1,011	1	8	19	54	662
Precinct 70	3,060	2,666	233	85	76	207	1,463
Precinct 71	2,207	2,100	30	40	37	82	1,475
Precinct 72	1,420	1,330	25	12	53	66	789
Precinct 73	2,193	1,832	172	102	87	140	1,203
Precinct 74	2,567	1,901	436	88	142	283	1,020
Precinct 75	1,305	1,218	28	20	39	51	714
Precinct 76	3,491	2,549	648	137	157	440	1,388
Precinct 77	1,682	1,576	58	16	32	85	1,228
Precinct 78	3,103	2,310	464	175	154	253	1,342
Precinct 79	925	912	3	3	7	56	656
Precinct 80	1,139	1,068	17	5	49	79	650
Precinct 81	845	817	6	4	18	46	460
Precinct 82	2,655	1,870	587	77	121	225	1,162
Precinct 83	662	639	6	5	12	40	380
Precinct 84	1,137	1,034	27	30	46	104	661
Precinct 85	1,468	1,353	44	54	17	82	919
Precinct 86	1,045	1,000	14	17	14	65	609
Precinct 87	1,003	979	4	10	10	21	636
Precinct 88	811	804	2	1	4	28	519
Precinct 89	1,089	1,048	3	16	22	29	739

Date: Sep 12, 2001

Time: 2:01 PM

DB: GEO\_LA\_HSE

Plan Type: Congress7

# Assigned Districts - Splits

## Total Population Ethnic Breakout

### Plan: Congressional Consensus Plan B



	Tot Pop	Tot White	Tot Black	Tot Asian	Tot Other	Tot Hispanic	Reg Total
<b>District 1</b>							
* Jefferson							
Precinct 1	2,050	1,971	11	61	7	65	1,379
Precinct 2	1,389	1,310	8	50	21	60	971
Precinct 3	963	905	1	37	20	41	746
Precinct 4	833	794	0	26	13	28	651
Precinct 5	926	883	3	31	9	35	717
Precinct 7	1,256	1,194	9	30	23	85	820
Precinct 8	884	820	10	23	31	81	600
Precinct 9	2,979	2,070	491	275	143	271	1,115
Precinct 10	1,129	1,065	18	18	28	66	738
Precinct 11	1,831	1,447	164	132	88	218	943
Precinct 12	1,550	1,401	14	114	21	75	1,205
Precinct 13	1,966	1,819	17	85	45	118	1,270
Precinct 14	624	577	1	25	21	39	494
Precinct 15	908	823	12	41	32	76	496
Precinct 16	887	822	5	45	15	35	576
Precinct 17	2,407	2,202	35	123	47	141	1,439
Precinct 18	2,087	1,788	76	93	130	290	1,197
Precinct 19	941	832	14	47	48	114	581
Precinct 20	1,332	1,175	31	84	42	102	578
Precinct 21	1,301	1,191	31	47	32	100	824
Precinct 22	755	646	42	37	30	79	376
Precinct 23	2,786	1,886	315	236	349	538	826
Precinct 24	2,286	2,109	15	136	26	97	1,634
Precinct 25	1,846	1,750	4	76	16	62	1,460
Precinct 26	2,508	2,019	166	131	192	376	1,351
Precinct 27	4,010	2,597	663	311	439	872	1,385
Precinct 28	1,010	871	40	65	34	64	545
Precinct 29	1,131	964	35	75	57	147	577
Precinct 30	1,430	1,367	14	25	24	60	978
Precinct 31	1,282	1,151	25	69	37	91	760
Precinct 32	1,138	1,092	2	35	9	21	934
Precinct 33	1,230	1,066	91	51	22	62	751
Precinct 34	1,059	1,031	2	16	10	23	781
Precinct 35	784	764	5	11	4	24	570
Precinct 36	689	656	2	23	8	18	483
Precinct 37	1,057	1,031	2	7	17	57	739
Precinct 38	1,126	1,099	3	8	16	45	779
Precinct 39	1,012	987	2	12	11	27	749
Precinct 40	839	821	0	11	7	22	650
Precinct 41	979	948	0	25	6	45	685
Precinct 42	1,245	1,125	38	53	29	69	813

Date: Sep 12, 2001  
 Time: 2:00 PM

# District Summary

VOT REG ALL

Plan: Congressional Consensus Plan B



DB: GEO\_LA\_HSE  
 Plan Type: Congress7

Name	Reg Total	Reg White	Reg Black	Reg Other	Reg Dem Total	Reg Rep Total	Reg Oth Total
District 1	367,893	312,601	38,253	17,039	168,995	128,340	70,558
	76.738%	84.971%	10.398%	4.632%	45.936%	34.885%	19.179%
District 2	335,388	113,329	203,071	18,988	231,890	40,845	62,653
	73.221%	33.796%	60.548%	5.662%	69.141%	12.178%	18.681%
District 3	370,230	278,131	82,597	9,502	237,953	72,880	59,397
	81.360%	75.124%	22.310%	2.567%	64.272%	19.685%	16.043%
District 4	342,968	234,114	99,886	8,968	204,261	78,611	60,096
	73.801%	68.261%	29.124%	2.615%	59.557%	22.921%	17.522%
District 5	370,421	255,403	109,696	5,322	234,368	79,894	56,159
	79.272%	68.949%	29.614%	1.437%	63.271%	21.568%	15.161%
District 6	355,714	250,571	94,074	11,069	196,321	94,034	65,359
	76.402%	70.442%	26.447%	3.112%	55.191%	26.435%	18.374%
District 7	381,621	276,813	97,673	7,135	252,598	67,603	61,420
	83.014%	72.536%	25.594%	1.870%	66.191%	17.715%	16.095%
<b>Grand Total:</b>	<b>2,524,235</b>	<b>1,720,962</b>	<b>725,250</b>	<b>78,023</b>	<b>1,526,386</b>	<b>562,207</b>	<b>435,642</b>
	<b>77.688%</b>	<b>68.178%</b>	<b>28.731%</b>	<b>3.091%</b>	<b>60.469%</b>	<b>22.272%</b>	<b>17.258%</b>



Date: Sep 12, 2001

Time: 1:59 PM

DB: GEO\_LA\_HSE

Plan Type: Congress7

# District Summary

## Total Population Ethnic Breakout

### Plan: Congressional Consensus Plan B



Page: 1 of 1

Name	Tot Pop	Tot White	Tot Black	Tot Asian	Tot Other	Tot Hispanic	Reg Total
District 1	638,385	521,299	89,588	11,992	15,506	30,972	367,893
	100.000%	81.659%	14.034%	1.878%	2.429%	4.852%	75.738%
District 2	638,243	195,199	411,996	18,011	13,037	24,177	335,388
	100.000%	30.584%	64.552%	2.822%	2.043%	3.758%	73.321%
District 3	638,815	458,213	154,587	7,958	18,057	12,173	370,230
	100.000%	71.729%	24.199%	1.246%	2.827%	1.906%	81.360%
District 4	638,510	404,220	214,179	5,697	14,414	13,068	342,968
	100.000%	63.307%	33.544%	0.892%	2.257%	2.047%	73.801%
District 5	638,870	412,985	214,635	3,803	7,447	8,486	370,421
	100.000%	64.643%	33.596%	0.595%	1.166%	1.328%	79.272%
District 6	637,655	417,418	203,001	10,091	7,145	10,587	355,714
	100.000%	65.461%	31.836%	1.583%	1.121%	1.660%	76.402%
District 7	638,498	446,827	180,331	4,852	6,488	8,275	381,621
	100.000%	69.981%	28.243%	0.760%	1.016%	1.296%	83.014%
<b>Grand Total:</b>	<b>4,468,976</b>	<b>2,856,161</b>	<b>1,468,317</b>	<b>62,404</b>	<b>82,094</b>	<b>107,738</b>	<b>2,524,235</b>
	100.000%	63.911%	32.856%	1.396%	1.837%	2.411%	77.686%

Date: Sep 12, 2001

Time: 2:00 PM

# Plan Statistics

## Plan: Congressional Consensus Plan B



DB: GEO\_LA\_HSE

Plan Type: Congress7

Page: 1 of 1

<u>Districts:</u>	<u># of Members</u>	<u>Actual Population</u>	<u>Ideal Population</u>	<u>Absolute Deviation</u>	<u>Relative Deviation</u>
District 1	1	638,385	638,425	-40	-0.006%
District 2	1	638,243	638,425	-182	-0.029%
District 3	1	638,815	638,425	390	0.061%
District 4	1	638,510	638,425	85	0.013%
District 5	1	638,870	638,425	445	0.070%
District 6	1	637,655	638,425	-770	-0.121%
District 7	1	638,498	638,425	73	0.011%

<b>Grand Total:</b>	<b>7</b>	<b>4,468,976</b>	<b>4,468,975</b>
---------------------	----------	------------------	------------------

<b>Ideal Population Per Member:</b>	638,425		
Number of Districts for Plan Type:	7		
Range of District Populations:	637,655	to	638,870
Absolute Mean Deviation	174		
Absolute Range:	-770	to	445
<b>Absolute Overall Range:</b>	<b>1,215</b>		
Relative Mean Deviation:	0.00%		
Relative Range:	-0.12%	to	0.07%
<b>Relative Overall Range:</b>	<b>0.19%</b>		

<i>Ideal - Actual:</i>	<i>-1</i>
<i>Remainder:</i>	<i>1</i>
<i>Unassigned Population:</i>	<i>0</i>

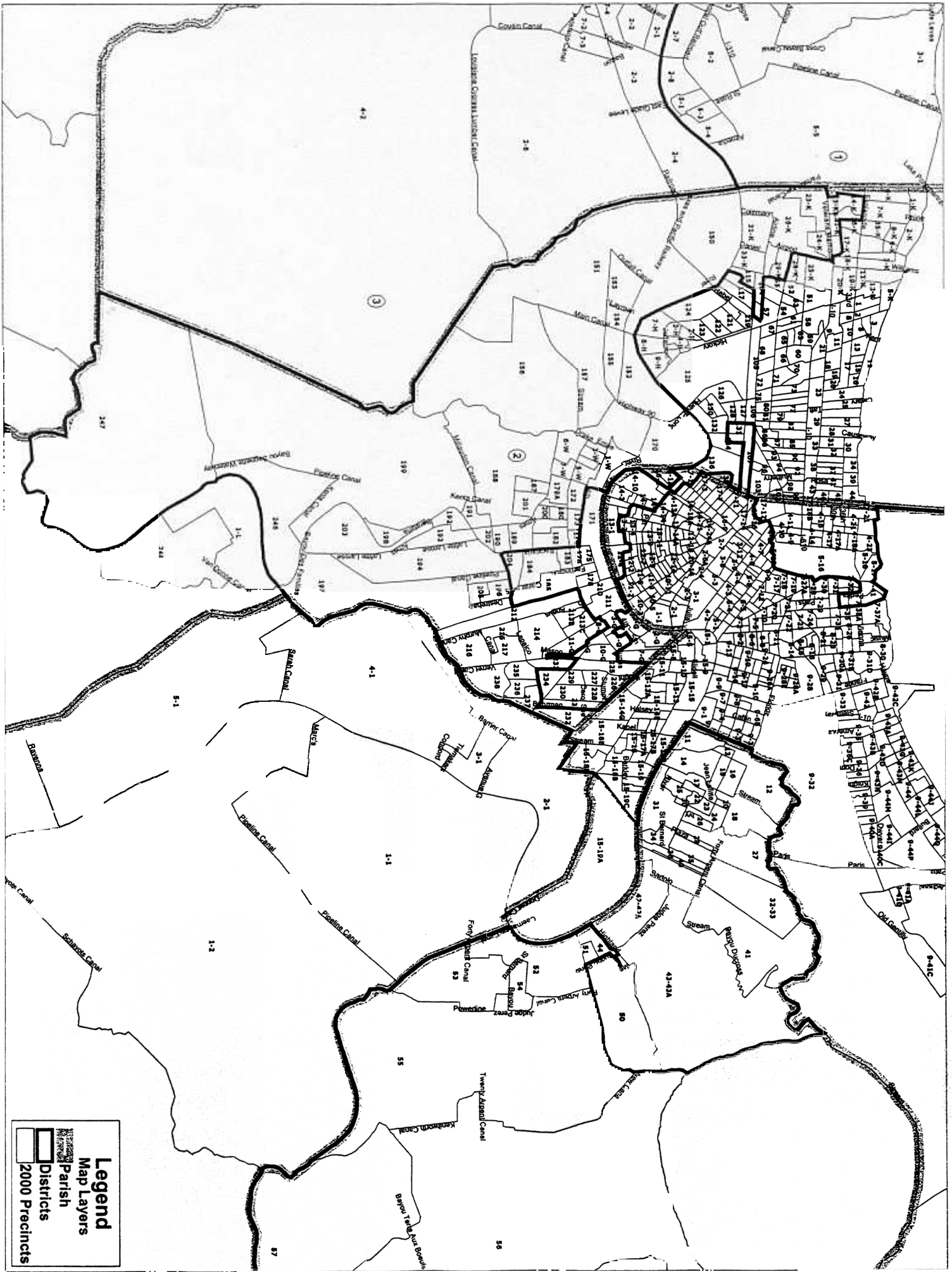

**Legend**  
 Map Layers  
 Parish  
 Districts  
 2000 Precincts

stional Consensus Plan B: Ascension

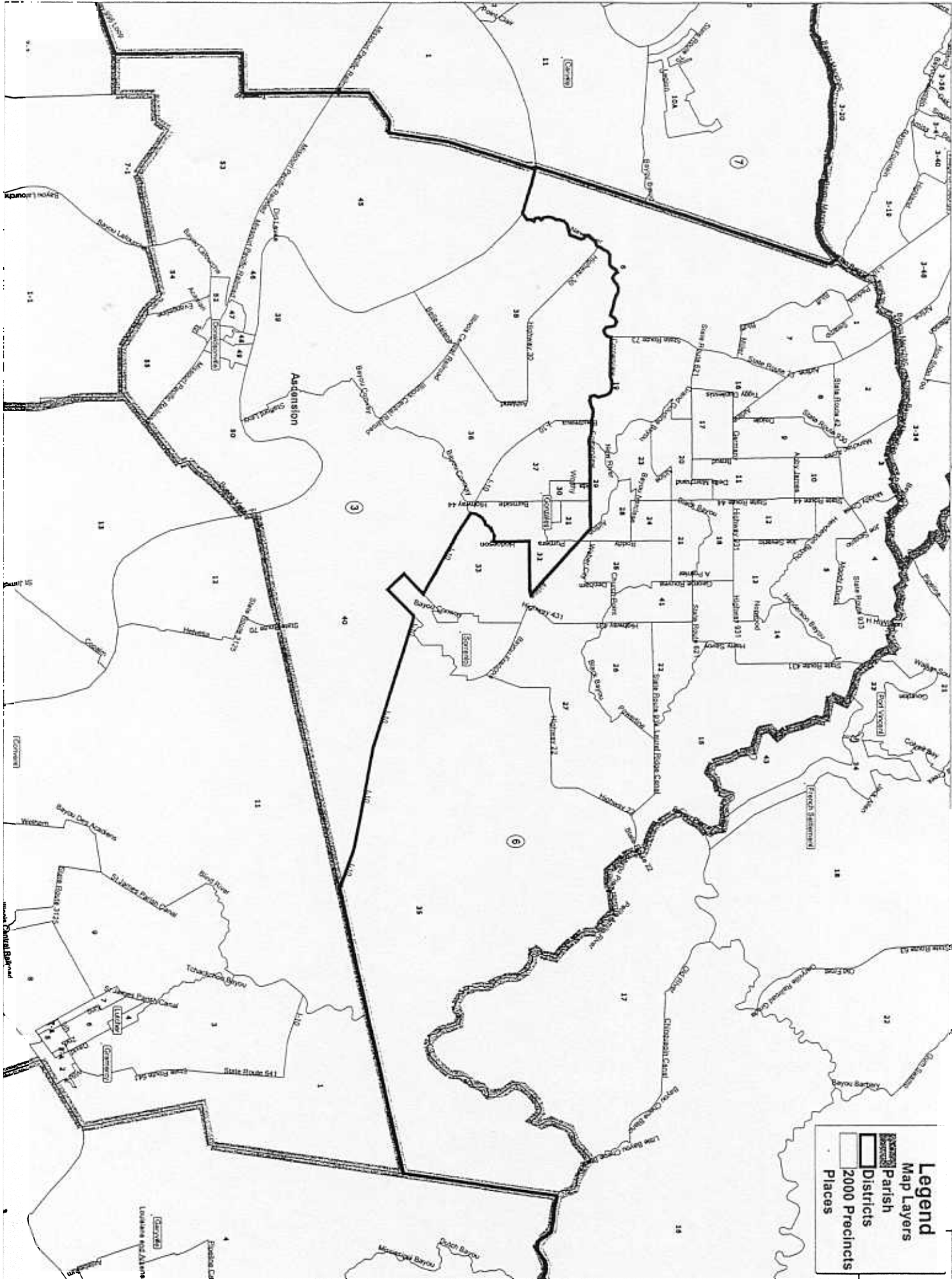

**Legend**  
 Map Layers  
 Parish  
 Districts  
 2000 Precincts  
 Places

Congressional Consensus Plan B: Lafayette

**Legend**  
Map Layers  
Parish  
Districts  
2000 Precincts  
Places

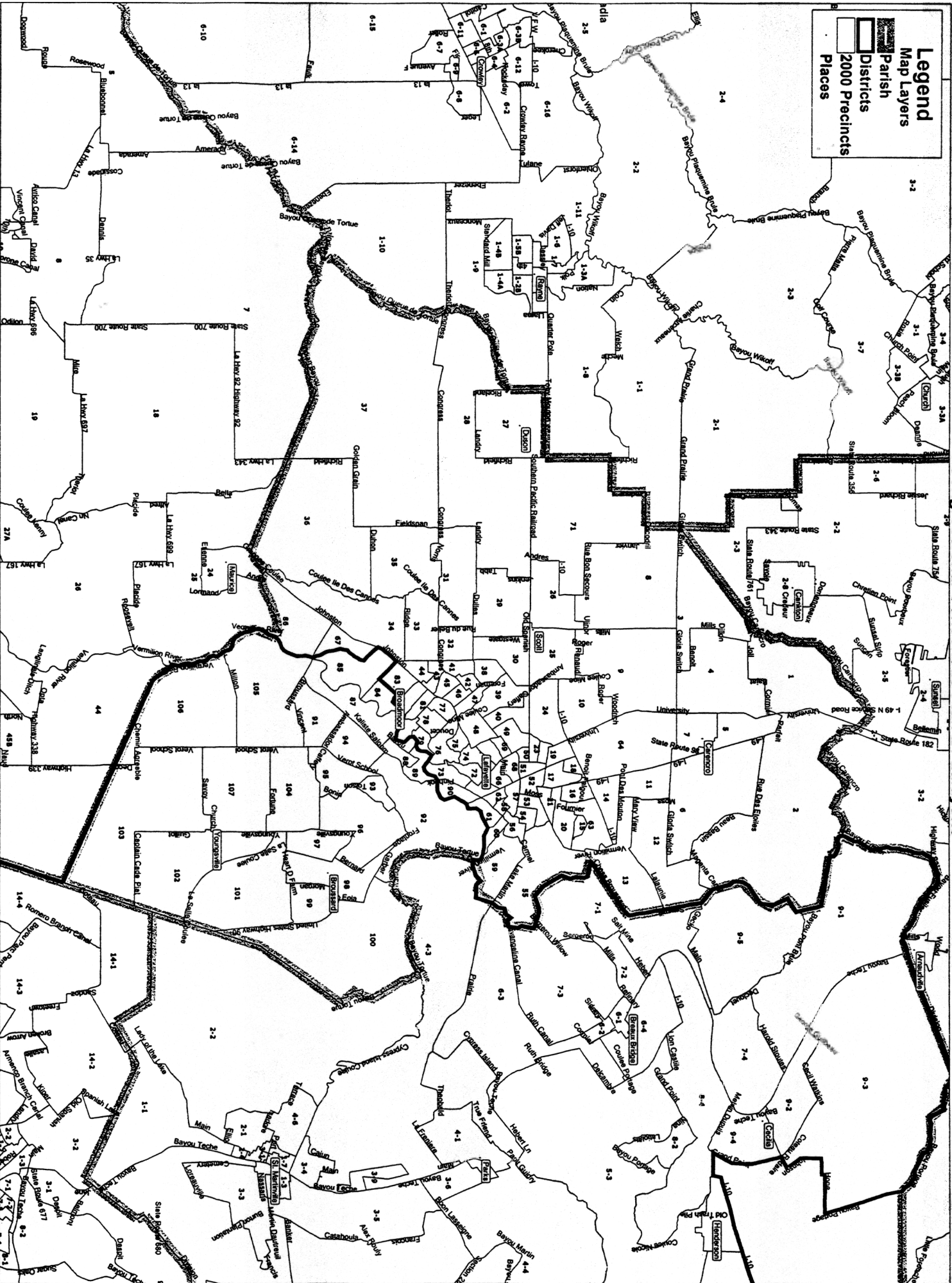

**Legend**

- Parish
- Districts
- 2000 Precincts
- Places

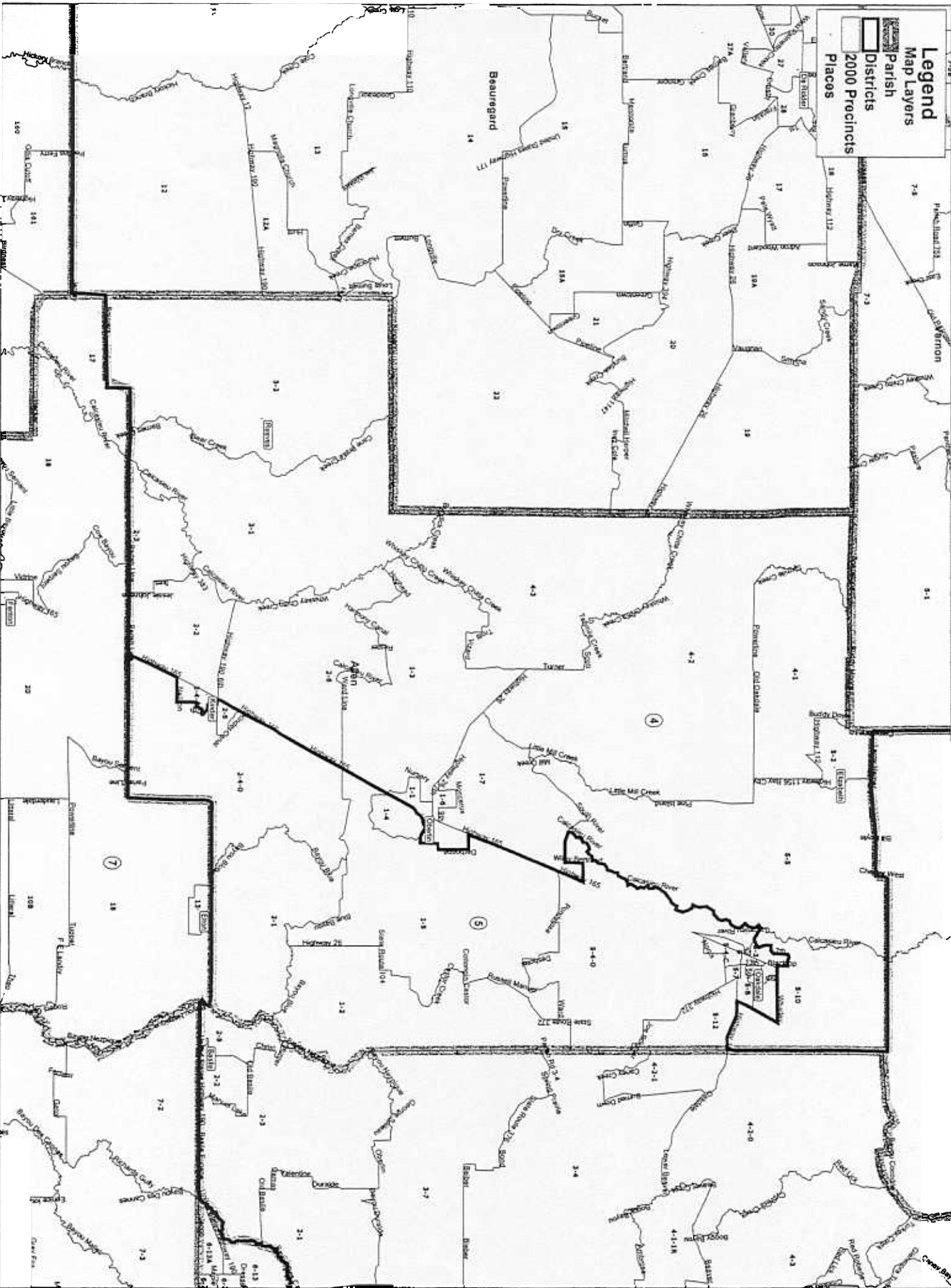

Date: Sep 12, 2001

Time: 2:01 PM

# Assigned Districts - Splits



DB: GEO\_LA\_HSE

Plan Type: Congress7

## Total Population Ethnic Breakout Plan: Congressional Consensus Plan B

Page: 30 of 30

	Tot Pop	Tot White	Tot Black	Tot Asian	Tot Other	Tot Hispanic	Reg Total
Precinct 78	1,897	1,747	120	22	8	18	1,326
Precinct 79	785	778	0	1	6	10	594
Precinct 80	891	873	4	5	9	3	690
Precinct 81	934	887	22	18	7	13	635
Precinct 82	1,814	1,677	92	7	38	40	1,147
Precinct 83	2,302	2,217	25	23	37	43	1,582
Precinct 86	2,197	2,015	111	52	19	50	1,280
Precinct 90	917	826	72	8	11	9	683
<b>Lafayette</b>	<b>139,405</b>	<b>94,412</b>	<b>41,514</b>	<b>1,728</b>	<b>1,751</b>	<b>2,348</b>	<b>80,336</b>
St. Landry	87,700	49,555	37,287	231	627	794	50,025
* St. Martin							
Precinct 8-3	1,743	1,579	161	1	2	16	1,153
<b>St. Martin</b>	<b>1,743</b>	<b>1,579</b>	<b>161</b>	<b>1</b>	<b>2</b>	<b>16</b>	<b>1,153</b>
Vermilion	53,807	44,488	7,800	1,052	467	742	32,697
West Baton Rouge	21,601	13,561	7,740	53	247	313	13,662
<b>District 7</b>	<b>638,498</b>	<b>446,827</b>	<b>180,331</b>	<b>4,852</b>	<b>6,488</b>	<b>8,275</b>	<b>381,621</b>